



RESIDENCE OFFER BOOK 2026

Western
UNIVERSITY • CANADA



We acknowledge that Western University is located on the traditional lands of the Anishinaabek, Haudenosaunee, Lūnaapéewak and Chonnonton Nations, on lands connected with the London Township and Sombra Treaties of 1796 and the Dish with One Spoon Covenant Wampum. With this, we respect the longstanding relationships that Indigenous Nations have to this land, as they are the original caretakers. We acknowledge historical and ongoing injustices that Indigenous Peoples (First Nations, Métis and Inuit) endure in Canada, and we accept responsibility as a public institution to contribute toward revealing and correcting miseducation as well as renewing respectful relationships with Indigenous communities through our teaching, research and community service.



Medway-Sydenham Hall Residence

Welcome



On behalf of the entire Housing team, we offer you a warm welcome to Western's residence community. We are committed to providing you with an incredible residence experience and are excited to show you the many benefits that life in residence can provide.

Living in residence offers a unique opportunity to discover more about yourself, connect with others, and engage with people from diverse backgrounds. As a part of our community, you will find many opportunities to take on leadership roles, get involved in a variety of activities, and build meaningful, lasting friendships.

Living in residence for the first year of your university life will support and enrich your academic experience. Our research consistently shows a strong relationship between living in residence and academic success. Living right on campus puts you at the centre of everything—you're a quick walk to class or to one of Western's many libraries. Residence provides easy ways to find others to form study groups, collaborate and prepare for exams. You also have convenient, exclusive access to study spaces. We strongly believe that your residence environment provides the positive support to help you focus on your academic success.

Our on-campus residences offer unmatched convenience, placing you steps away from Western's recreation centre and bus stops that connect you to London's vibrant cityscape.

We are proud of our residence facilities and the variety of room options available to you. Please check our website for more information or let us know if we can assist you in any way.

Again, on behalf of the Department of Housing, welcome to Western University. Best wishes for a rewarding and memorable academic year.

A handwritten signature in black ink, appearing to read 'Chris Lengyell'.

Christopher Lengyell, Director of Housing

What's Inside

- 4** The Residence Guarantee
- 5** Residence Advantages
- 6** Residence Amenities
- 7** Styles of Residence
- 11** Academic Success in Residence
- 12** Living-Learning Communities
- 14** Lifestyle-Based Floors
- 15** Commitment to Diversity
- 16** Leadership Opportunities
- 18** Here to Support
- 19** Residence Dining
- 20** Residence Meal Plan
- 22** Connect to Internet
- 23** Safety and Security
- 24** Accessibility in Residence
- 25** Live on Campus After First Year
- 26** Residence Admissions FAQ
- 29** Residence Fees
- 30** Important Dates and Numbers

THE RESIDENCE GUARANTEE

A Place for *Everyone*

You are invited to become an important part of our residence community, where Western students live and learn together.

If you are a single student coming directly from high school and have received an offer of full-time, first year admission to Western University's Main Campus by mid-May, then **accommodation is GUARANTEED.**

Students transferring from other institutions or receiving their offer after mid-May, are invited to complete a residence application and join our wait list.

Scholarship recipients receiving awards from Western's National Scholarship Program*, the Schulich Leader Scholarship and the National Indigenous Scholarship are guaranteed single-room accommodation in their first and second year.

Recipients of the Western Scholarship of Excellence, are guaranteed one of their top three choices of residence building in their first and second year. Students will automatically be considered for the Western Scholarship of Excellence if they are admitted to an undergraduate program at Western's Main Campus directly from secondary school and are

registered in first year full-time studies. No application is required.

All international students are guaranteed a space in residence during their first and second year of study at Western.

Recipients of the Welcome-to-Canada Scholarship will be guaranteed a space in residence for their first and second year.

If you are a high school student on a study permit in Canada and a recipient of Western's Continue-in-Canada Admission Scholarship, you will be guaranteed a space in residence for all four years of your undergraduate studies, in addition to a scholarship of \$40,000 over four years.

** Neen Hodgins National Entrance Scholarship, President's Entrance Scholarships, James Jenkins President's Entrance Scholarship for Black Students, Beryl Ivey Continuing Entrance Scholarship, Neen Hodgins President's International Entrance Scholarship, International President's Entrance Scholarships, and Faculty Entrance Scholarships.*

The fine print:

All residence guarantees listed above are contingent upon meeting our eligibility requirements and deadlines.

First-year students who do not meet our guaranteed offer requirements are still eligible to apply to the residence waiting list if they are single and are academically admissible for full-time studies on Main Campus.

Students registering at Huron University College or King's University College are not eligible for residence at Western's Main Campus.

Students with families are encouraged to contact Platt's Lane Estates, our University-owned family accommodation.

Information, policies and procedures contained in this document are subject to change, pending new guidance and recommendations from the University and/or local/provincial/federal agencies and leaders.

1st

in the 'Residence Living' category in *Maclean's University Rankings* seven years in a row

3

building styles to choose from

**12
residences**

conveniently located on campus—all within a 10-minute walk to class

**6,100
residence
spaces**

guaranteeing incoming first-year students a place in residence

80%

of first-year students choose to live in residence, giving them an academic advantage and easing their transition to university



Did you know?

Studies show that students living in residence achieved higher averages compared with their peers living off campus.*

Residence *Advantages*

Academic edge

Students who live in residence are more successful academically. There are many programs in residence that support your academic efforts—'Professor Meet and Greet' events, exam review sessions, peer study groups and academic skills workshops—all right where you live!

Clean and cared-for facilities

We are continually upgrading and renovating our buildings to ensure that you can enjoy high-quality, well-equipped accommodations. We also provide regular cleaning of common areas on your floor every day.

Convenient and easy access

Living on campus means that you are always close to your classes, campus services and co-curricular involvement opportunities. Meeting with a professor or studying in the library is only a short walk away.

Dining at ease

Our eight residence dining halls offer easy access to a diverse range of dining options. Our chefs prepare a wide selection of food in-house so there's always something new to try. You can dine in on campus, order in or dine out with our off-campus meal plan partners—all on your residence meal plan!

Focus on safety

Every residence has a front desk that's only a call away, live-in Residence Dons that are here to support, Residence Safety Assistants that respond to overnight concerns and guest registration staff on the weekends. Someone is always available to help. Western Special Constables provide 24/7 patrols and emergency response service 365 days a year, while Foot Patrol provides safe escorts to walk students to their destinations on main campus and the Affiliate University Colleges at night. Western also has a Student Emergency Response Team which responds to oncampus medical emergencies.

Growing your leadership skills

Expand your personal and professional skills through involvement in numerous academic, social, cultural and recreational activities just steps away from your door! Through a variety of events, you can gain valuable leadership skills to help you land your dream job. Residence Life has several involvement opportunities including Residents' Council, Residence Life Staff and the Residence Orientation Program.

Internet connection

Residence offers easy access to high-speed internet and to academic resources such as our learning management system (OWL), the Western Library system and Western email. Students have convenient wireless access available throughout all residence buildings in addition to our high-speed wired internet service. Need help connecting? Our Connect-IT team is available to help you get connected on move-in days and all year long.

Making new friends

Residence enables you to easily meet new people and make connections with hundreds of other first-year students. Making new friends is one of the best parts of living in residence.

Seamless move-in

Once you arrive to Western, you'll receive a warm welcome and directions on where to go—making your move-in day stress-free for you and your family.

Variety of building & room options

With 12 residence buildings in three different styles, you have a lot of different options to choose from—all of which offer the same great convenience, events and leadership opportunities.

EVERYTHING YOU NEED UNDER ONE ROOF

Residence Amenities

- Workout rooms, music practice rooms and laundry facilities
- Our eight residence dining halls provide delicious, home-cooked meals. You are never more than a few minutes' walk away from your closest dining hall
- Main lounges for residence events—equipped with table tennis and/or pool tables, plenty of couches and TVs
- Safety is important to us— Access to our buildings or residential areas is restricted 24/7 by a locked door which is controlled by card access
- Study rooms available in your building



Front desk services,
accessible in person or
by phone



Caretaking staff will provide
regular sanitization of common
spaces



Living-Learning Communities
in our buildings that group
residents who share the same
faculty, program or interests



Upper-year student leaders
living in residence, ready to
connect you to campus and
assist you with any questions
you may have



Traditional-Style Residence

Delaware Hall | Medway-Sydenham Hall |
Saugeen-Maitland Hall

A combination of single and double rooms along a hallway where residents share common washrooms with members of their floor community. Washrooms are separate for men and women and some floors have additional all-gender washrooms depending on the building.

- Most economical room rate
- Easy to make friends and meet others
- Strong sense of community and belonging
- Floor washrooms with private showers are cleaned daily
- About 30 students on each floor

We offer single-gender rooms in traditional-style buildings. Mixed-gender rooms are only offered if students explicitly request the option.

Note: All floor plans are for illustrative purposes only and may not reflect the exact layout of every residence building.

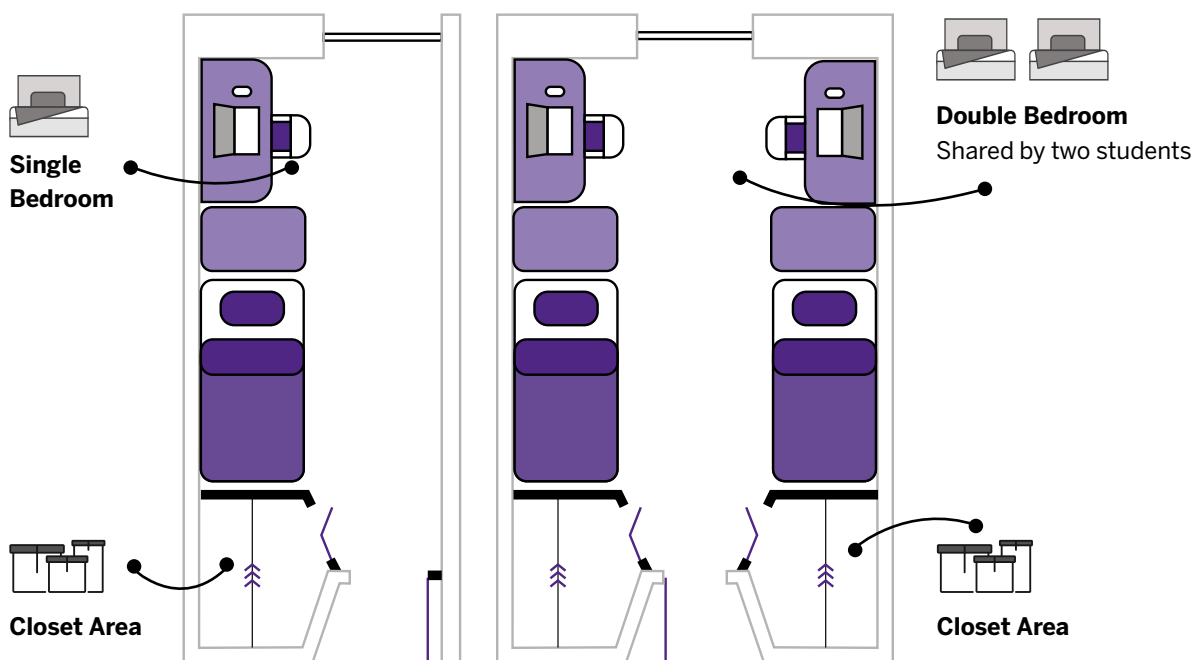

Hybrid-Style Residence

Bayfield Hall | Clare Hall | Ontario Hall | Perth Hall

Mostly double rooms (and some singles) where students share a bedroom and a private washroom. Bayfield Hall suites also contain a shared kitchen and living area.

- Strong sense of community similar to traditional-style
- Extra storage in common area of semi-suite
- Extra common-area sink in semi-suites with double rooms
- Cleaning supplies available at front desks

Clare Hall is an all-women residence. Mixed-gender rooms or suites are only offered in buildings if students explicitly request the option.

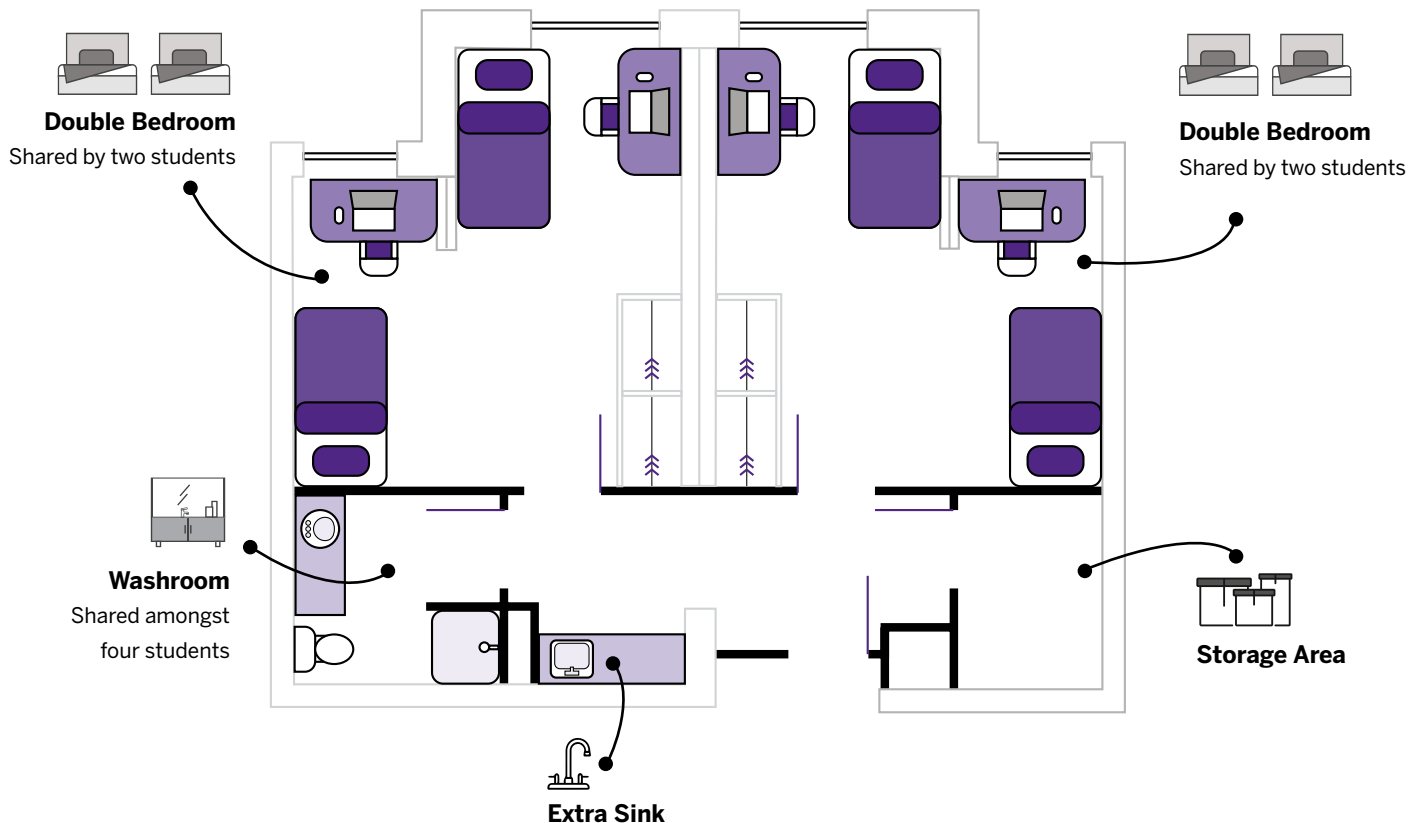

Suite-Style Residence

Elgin Hall | Essex Hall | Alumni House
Lambton Hall | London Hall

Two, three or four single rooms form a suite and share a kitchenette and living area, as well as one or two washrooms, depending on the building.

- Geared towards independent living with more domestic responsibilities
- Has increased privacy with individual bedrooms and fewer students sharing washroom facilities
- Shared kitchen and living area space
- Cleaning supplies available at front desks

We offer single-gender and mixed-gender suites depending on students' identified preferences.

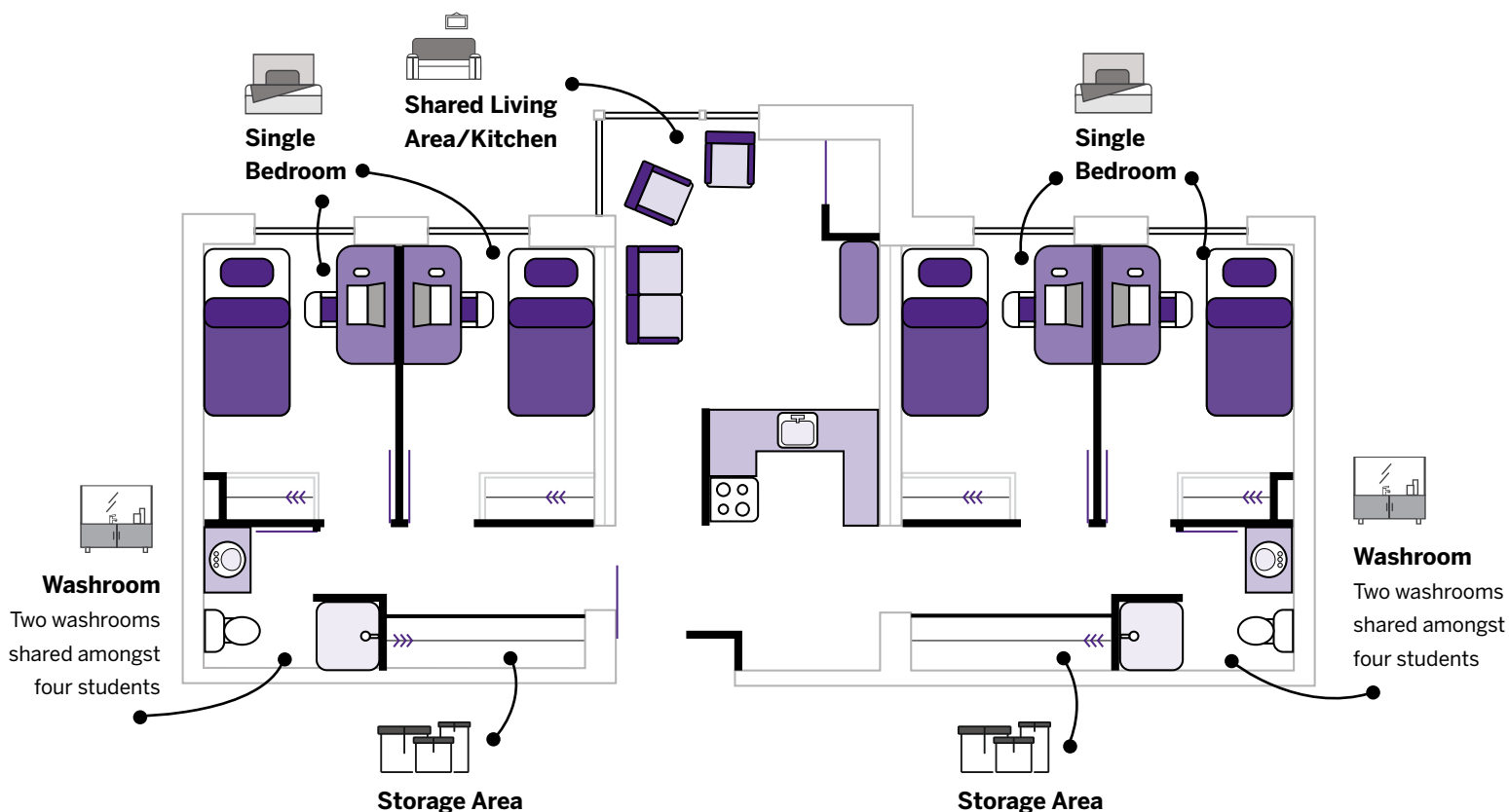



How to Choose Your Residence

HOW ARE RESIDENCES ASSIGNED?

We ask you to rank all of our residences, from most-desired to least-desired, on your Residence Placement Questionnaire. Consider the style of residence, single- or mixed-gender room options, cost and the Living-Learning Community offerings. There are some single rooms available, though we can't guarantee this option.

Building assignments are made using a computer-generated number, randomly assigned to each student. Placement is based on your ranked preferences of buildings. If your most preferred residence in your ranked list is filled by the time your number is picked, you will be assigned to the next available residence in your list of preferences.

HOW DO I RANK MY RESIDENCE CHOICES?

We offer the same programs and activities in every residence. More importantly, the same strong sense of community and belonging develops among members of each floor community in all the residences, big or small. You will be able to walk to the centre of campus in ten minutes from any residence. If you don't get one of your top choices, not to worry as each residence building offers a close-knit community, unique culture and opportunities to take advantage of!

HOW DO YOU MATCH ROOMMATES?

We make every effort to match people with similar lifestyle habits, such as whether they study with or without music in the background, whether they prefer to go to bed early, how often they clean their room and more, based on their answers on the Residence Placement Questionnaire.

Please note that attitudes towards smoking, vaping, cannabis and alcohol use, along with age, take precedence in the placement process over other lifestyle habits.

We respect that a person may wish to live with students irrespective of their or others' gender identity or expression. Both single-gender and mixed-gender rooms and suites are available for students to choose from when you fill in the online Residence Placement Questionnaire at myhousing.uwo.ca.

HOW DO I GUARANTEE MY ROOMMATE?

First-year incoming students may request one roommate in any style of building to form a roommate group of two. To be part of a guaranteed roommate group, both members must receive guaranteed residence offers. Additionally, they must submit their residence prepayment and complete the Residence Placement Questionnaire by the June deadline. Both roommates need to join the same roommate group on the myHousing Portal. Depending which roommate sends the request, please ensure you return to the 'Roommate Groups' section in your residence application to accept the request to join the roommate group. To ensure a compatible living experience, it is strongly recommended that roommates discuss their building preferences and lifestyle choices.

About Mixed-Gender Housing in Residence

If you select the option for 'Mixed-Gender Suites' in the online Residence Placement Questionnaire, we will not consider your gender identity when placing you in a suite with other students. You will be matched with someone based on lifestyle preferences (tidiness, study habits, etc.).

As a result, you might be assigned a suitemate(s) of the same gender, or with someone whose gender identity is different than yours. Mixed-gender housing is an opt-in process and accommodation will be available based on demand.

Although we are happy to support students who choose mixed-gender housing in all room styles, we find that it works best in suite-style and single-hybrid style. Should you wish to live in mixed-gender housing in a shared double-bedroom, reach out to housing@uwo.ca to manage your request.

Clare Hall is an all-women residence. The Mixed-gender housing option is not available in this building.

Please note that your gender preference only applies to your suite. All but a few of our floors and residences are mixed-gender.

GIVE YOURSELF AN ACADEMIC EDGE

Academic Success in Residence

Learning is not limited to opening a book or participating in a lecture. We learn from every moment, situation and personal encounter.

Western promotes a residence atmosphere that's conducive to sleep and study at all times. Our staff are available to respond to any noise disturbances that might occur. Residence Life Staff and Sophs help floormates set guidelines to maintain a mutual level of respect and understanding of one another's need for an environment that encourages academic study.

- 24-hour quiet hours are strictly enforced during exam periods, while 11:00 p.m.–8:00 a.m. quiet hours are set for regular school nights
- Structured programs are run throughout the year to connect you with others in your classes and with professors from your faculty and program

- Organized study groups and academic support sessions are available throughout the year
- In addition to the wired internet service in your bedroom, wireless service is available in all residences

Studying for university takes personal discipline and self-management skills no matter where you live. Give yourself an academic edge by living and learning in residence!

Study Rooms

Enjoy a casual, relaxed setting where you can work on your studies with some friendly support right in your residence. Residence Education Advisors (REAs) regularly use these spaces to meet one-on-one with students and run workshops designed to help students succeed academically.



Our Learning Goals

We want you to get the most out of your experience at Western—and living in residence is the start of that journey. Residence events and programs are designed with three key learning goals in mind that will teach you how to thrive in university and in life after graduation.



Intellectual Engagement: Through interactions with faculty, staff and peers, you will be challenged to think critically, apply knowledge and connect classroom learning to life experiences.



Citizenship: By living in a community, exploring new cultures and learning more about social issues, you'll discover and refine your perspective, individuality and impact on society.



Self-Awareness: Learn to reflect on personal growth and change—whether it be physical, psychological, social or intellectual and gain the ability to recognize a realistic self-concept relating to confidence, integrity and personal limitations.

“ Residence Life provides many opportunities that will allow you to succeed. You will be surrounded by hundreds of other students who are eager to work collaboratively on course work. Orientation Leaders and Residence Life Staff also work very hard to ensure that you have the opportunity to meet your personal and academic goals.”

— Nicholas M., Social Science



Living-Learning Communities

Did you know?

More than 1,200 residents attend the “Get the Scoop” workshop every September to learn about academic transition from Residence Education Advisors and Learning Skills Counsellors.

One of our most effective, high-impact and immersive programs in residence.

Living-Learning Communities (LLCs) are floors in residence for students who want to live with other students that may share commonalities with them. There are floors for students who share a faculty/program, share an identity and/or lived experience.

LLCs are developed to give students a more enriched living and learning environment, combining academic integration, personal development and community engagement.

LLCs offer students additional benefits, including:

- An easy way to meet peers who share the same interests and academic goals
- Easier access to study groups and social events
- Programs and events tailored to fit their needs, goals and interests

- Multiple upper-year mentors who have shared lived experiences
- Enhanced opportunities for career and life-skill development
- Experiential learning opportunities connected with their community
- An increased sense of belonging in a particularly supportive environment

All LLCs are optional for students and there is no additional cost to live on any of these floors.

***You will receive confirmation of your acceptance before move-in.**

CLARE HALL



Computer
Science

DELAWARE HALL



Music



Nursing

ELGIN HALL



Scholar's
Electives
Program



Medical
Sciences

ESSEX HALL



Engineering

MEDWAY-SYDENHAM HALL



Health
Sciences



Arts &
Humanities



Science

PERTH HALL



Media,
Information
& Technoculture



Management &
Organizational
Studies



Computer
Science

ONTARIO HALL



Integrated
Science



2SLGBTQ+
and Ally



School of Advanced
Studies in Arts &
Humanities

SAUGEEN-MAITLAND HALL



Engineering



Kinesiology



Management &
Organizational
Studies



2SLGBTQ+ AND ALLY COMMUNITY

Do you feel passionate about expanding your knowledge in the area of gender identity, sexuality and social issues? The 2SLGBTQ+ and Ally Community welcomes all members of the Twospirited, Lesbian, Gay, Bisexual, Transgender, Transsexual, Queer and Questioning community, and their Allies (those who support and positively affirm all members of the Queer community). This community offers a supportive environment for students questioning their gender and/or sexuality, advocates for 2SLGBTQ+ rights and strives for an environment where all residents feel celebrated and empowered.



Lifestyle-Based Floors

In addition to our Living-Learning Communities, we also offer Lifestyle-Based Floors. Students who share the same lifestyle can choose to live together on these floors, available in Saugeen-Maitland Hall and Medway-Sydenham Hall.

Substance-free floors are for students (regardless of age) who commit to a substance-free lifestyle and want to live among others who have chosen the same. Each member on the floor is responsible for maintaining the integrity of this option.

Quieter lifestyle floors are for those who prefer to live in an environment with greater restrictions on noise. Standards for quiet are set by the residents of each floor.

Single-gender (woman-identifying) floors are offered for those who choose this option, based on demand.

In addition, Clare Hall is an all-women residence, based on demand.

Selection Process

If you are interested in applying to one or more of the Living-Learning Communities or Lifestyle-Based Floors, please indicate your preferences in the online Residence Placement Questionnaire. You will be placed accordingly, based on availability.

Students who apply to our 2SLGBTQ+ and Ally Community answer brief questions to assist in the placement process.

All of these floors are arranged as demand dictates. Certain options may not be offered if we don't have sufficient student interest to fill a full floor. While we do our best, we cannot guarantee placement on the floor of your choice.



Commitment to Diversity

Living in residence means that you have rights. You also have responsibilities. It's essential that you respect the rights of your fellow residents, including our commitment to diversity. Respecting others will make them more likely to respect you in turn. Residence living requires a spirit of mutual respect and cooperation.

Take care of yourself
Take care of each other
Take care of this place

We're all part of Western's diverse community. We embrace, appreciate and celebrate people of all races, nationalities, sexes, ages, gender identities and expressions, affectional and sexual orientations, socioeconomic statuses, spiritual practices, abilities and any other dimension of identity. Our community is strengthened by diversity and the growth fostered by an inclusive residence environment. Every person has equal worth and deserves to be treated with

dignity and respect.

We live and learn together, maintaining an environment of mutual respect and interpersonal curiosity, while striving to have positive interactions with one another. We can learn from each other to gain a greater understanding and appreciation for our fellow people.

We're responsible for our actions and our behaviour reflects our values. Any form of abuse, harassment, threat or violence is incompatible with our philosophy and will not be tolerated. We don't accept ignorance, anger, alcohol or substance abuse as a valid excuse, reason or rationale for negative behaviour. Together, we create a supportive, inclusive community for students to live, learn and flourish.

We are here to help

If our housing features or roommate options do not support your gender identity/expression and/or sexual/affectional orientation, please contact housing@uwo.ca to discuss a placement that is right for you.

10%

of our residents are international, coming from 126 countries across the world

17%

of our residents identify as lesbian, gay, bisexual, transgender, two-spirited, transsexual, queer or questioning

92%

of our residents are 18 or younger when they arrive on move-in days

20%

of our residents hold part-time jobs while attending Western



LEADERSHIP OPPORTUNITIES

Stay Involved and Grow Your *Leadership Skills*

At Western, we believe that experiential learning plays an important role in students' academic success.

There are hundreds of student leadership positions available in residence—from Residents' Council to Residence Life Staff positions. By taking advantage of these opportunities, you will be able to leverage your skills, gain valuable experience and provide assistance to others, while also developing applicable leadership competencies for your future career.

Residence Dons

Residence Dons are part-time, upper-year student. Each community is assigned a Residence Don who lives on the floor and serves as a link between students and the University. Their

number one priority is to help make your Western experience the best it can be by answering questions, organizing activities, connecting you to campus resources and upholding residence policies.

Residence Education Advisors

Residence Education Advisors (REAs) are part-time, upper-year student leaders, trained to provide the support and assistance students need to make their academic transition to university successful.

Residents' Council

Residents' Council are elected or selected representatives of the residents. They organize social activities and programs including intramural sports, formals, special outings and study groups.

Residence Sophs

Residence Orientation Leaders, also known as 'Residence Sophs', are upper-year students who volunteer their time to share their own experience and help first-year students in their transition to university. Sophs are known as the 'spirit keepers' on campus, energizing students during Orientation Week, facilitating move-ins in September and providing peer support throughout the year.

Connect-IT Support Team

When students in residence are attempting to connect to the internet, Connect-IT is there to provide support. This part-time position for full-time students combines customer service experience and an opportunity to apply technical skills acquired during our annual staff training in August. The benefits of working with this team include competitive compensation, training, on-campus location, flexible hours, a student-run environment and an opportunity to expand your technical skills.

Front Desk Staff

Front Desk Staff look after our reception areas in the residence building lobbies. They provide front-line customer service, answer phones 24/7, greet guests, issue replacement keys, coordinate mail deliveries, dispatch on-duty Residence Life Staff to handle concerns and take maintenance requests. Part-time hours available for students.

Guest Registration

Guest Registration Staff are responsible for supporting Housing's Visitor Policy, by ensuring the students entering Western's main campus residences are registered residence students and/or registered guests. Staff are stationed at residence entrances during evenings, weekends and other high-traffic times. Part-time hours available for students.

HAS Street Team

Street Team members are part-time student staff who support the Division of Housing and Ancillary Services (HAS). They use their campus experience to lead residence tours, conduct surveys, create social media content and promote campus services such as apparel and meal plans.

“

Being on Residence Staff is a unique way to discover more about yourself, expand your social relationships and feel connected to campus. I wanted to finish my undergrad in a meaningful way, and considering this role was something I wanted to do, it seemed like a perfect fit!”

— Elise





We are here to *Support*

The Housing Office team of professionals are experienced in dealing with students' transition from high school to university life. We are committed to creating a supportive residence community that maximizes your potential for success.

Residence Life Coordinators

Residence Life Coordinators are full-time employees of the University who live and work in the residences. They are responsible for promoting an atmosphere of academic achievement, community living, as well as the enhancement of student learning outside of the classroom.

Residence Safety Coordinators

Residence Safety Coordinators are responsible for the afterhours emergency and safety responses in residence and regularly liaise with partners such as Campus Safety and Emergency Services. Their primary focus is on community management and student support and can help connect residents to supports on campus and in the London community.

Residence Safety Assistants

Residence Safety Assistants are full-time staff members dedicated to the community management and student support needs during peak periods of student activity including evenings, overnights and weekends. They conduct regular rounds of the buildings and help connect students to resources, as well as respond to concerns such as noise complaints and emergencies in residence.

Residence Counselling & Student Support

Residence Counselling offers confidential counselling services, free of charge, to students living in residence on a wide variety of issues including (but not limited to): adjustment to university, anxiety, depression, academic stress, motivation, grief, sexuality, gender identity, relationships, suicidal thoughts, self-harm, social skills, self-esteem and greater understanding of self. Our team of mental health professionals works closely with other campus departments to promote coordinated services for students living in residence and can facilitate referrals to specialized services when needed.

Facilities Management

Facilities Management Staff work during the day to ensure a clean and well-maintained living environment. They are also responsible for repairs and maintenance work.

Residence Conduct

Residence is the largest classroom on campus. When concerns arise regarding student behaviour, Residence Conduct staff members work with the student to educate about harm reduction and ensure they have the best experience possible. On occasion, conduct staff members also use a restorative approach to address harm to the community.

Dining Hall Staff & Registered Dietitian

Dining Hall Staff prepare your meals and snacks throughout the day and our Registered Dietitian can help answer any nutrition questions that you may have. Our chefs at the interactive stations will cook customized meals for you.



Residence Dining

Our dining halls serve diverse, globally inspired, homemade meals using locally sourced ingredients when possible.

Convenience

We're proud to offer eight conveniently located residence dining halls—you are never more than a few minutes' walk away from your closest dining hall. You can also use your meal plan at any of our residence dining halls, so it's easy to share meals with your friends from other buildings—you'll love the convenience!

Choices and flexibility

Check out our selection of affordable, à la carte menu options. You choose, and pay for, as much or as little of an item as you wish! Each dining hall features hot entrées prepared in-house by our skilled culinary teams, a full fruit and salad bar, deli bar, sushi, soups and convenient grab-and-go items.

Tailored to your dietary needs

It's easy to make healthy food choices in our residence dining halls, even for students with dietary restrictions. Our menus feature a wide variety of options including several plant-based, allergen-friendly, gluten free and halal selections. To assist students with managing their dietary and allergen needs, dietary and Health Canada priority allergens identifiers are displayed throughout the serveries to help you make an informed decision. This makes it easier for students with dietary restrictions to find safe foods.

At Western, we support students living with food allergies. If you have a food allergy or other dietary restriction, we strongly encourage you to self-identify. Please consider completing the 'Food Allergies and Dietary Needs' section of the myHousing Portal, submitting a Residence Accessibility Request on the myHousing Portal and sending an email to our Registered Dietitian (nutritionservices@uwo.ca) prior to moving in. Your safety is a shared responsibility so allow us to assist you in making an informed choice. For more information please refer to our nutrition website (nutrition.uwo.ca).

Sample Menu

Below is a sample of a residence dining hall menu. All students in residence (except those in Bayfield and Lambton Hall) are required to purchase a meal plan.

BREAKFAST

Eggs to Order
 Hayter's Farm Turkey Sausages
 Plant-Based Breakfast Sausage
 Breakfast Sandwiches (with and without meat)
 Baked Beans
 Breakfast Potatoes
 Smoothies and Smoothie Bowls
 Fresh Fruit
 Yogurt (regular and vegan)
 Hot and Cold Cereals (regular and gluten free)
 Breads, Muffins and Pastries (regular and gluten free)

LUNCH

Chicken Shawarma
 Eggplant Caprese
 Teriyaki Meatballs
 Coconut Crusted Tilapia
 Vegan Quinoa and Black Bean Burger
 "Beyond" Italian Sausage and Vegetable Toss
 Moroccan Lentil Stew
 Fresh Market Vegetables

DINNER

Buttermilk Fried Western Style Hot Chicken (regular and plant-based)
 BBQ Back Ribs
 Penne with Roasted Cherry Tomatoes
 Basil & Feta Cheese Pasta
 Fresh Market Vegetables
 Jalapeno Cheddar Cornbread
 Marinated Coleslaw
 Fresh Cut Fry Bar Assorted Garnishes
 Fresh Sandwich Deli

SOUP STATION (ALL DAY)

Homemade Butternut Squash Soup
 Prepared Italian Wedding Soup
 Beef Chili



*Did you
know?*

*The meal plan works like
a debit card with a
declining balance.*

UNDERSTANDING YOUR

Meal Plan

At Western, we offer our students two options in meal plans to help meet their individual preferences.

Meal Plan One

Ideal for students who dine in residence most of the time. This plan provides a balanced amount of food credit to enjoy meals, snacks and treats at any residence dining location. With some planning, this plan is designed to last through the academic year. Recommended for students living in traditional- and hybrid-style residences without in-suite cooking facilities.

Meal Plan Two

Ideal for students who want flexibility and independence. This plan offers a lower amount of food credit, giving students access to residence dining halls, while still leaving room to explore other options. Recommended for students in suite-style residences who plan to cook occasionally, often head home on weekends or those likely to try local restaurants around London. Students with higher on-campus dining needs or those who don't plan to cook often may find Meal Plan One a better fit.

Each residence meal plan includes three components: food credit, an overhead fee and a capital improvement fee.

Food Credit

There are two types of food credit in your meal plan, Residence Dollars and Flex Dollars.

Residence Dollars

These are used at residence dining halls and on-campus eateries. The cost of food purchased in the residence dining halls is reduced and tax-exempt to reflect that the overhead fee has been paid. When making purchases at on-campus eateries, you will pay full retail price, but tax-exemption still applies.

Flex Dollars

These can be used at on-campus vending machines and partner restaurants on and off campus, including take-out and delivery. Off-campus purchases are subject to full retail price plus taxes.

Overhead Fee

The overhead fee is used to operate the dining facilities, including labour, utilities, etc. There is no food credit value to the overhead fee and it is non-refundable.

Capital Improvement Fee

The Capital Improvement Fee is a charge that goes towards funding improvements to facilities and equipment within residence dining and is non-refundable.

WILL MY MEAL PLAN CREDIT LAST ALL YEAR?

Whether the meal plan will cover all of your meals for the academic year very much depends on your eating habits. Eating in the residence dining halls will help make your food credit last throughout the academic year since the overhead fee is taken off at takeout giving you a 50% discount on majority of items. You can add more food credit online at any time and are not required to pay further overhead costs when doing so.

WHAT IF I HAVE FOOD CREDIT LEFT OVER BY THE END OF THE YEAR?

At the end of the academic year, any unused food credit (Residence Dollars and Flex Dollars) can be transferred to a campus meal plan for the following year. Alternatively, you may request any unused food credits to be applied as a credit back to your Student Center account. Remember, the overhead fee is non-refundable. Visit food.uwo.ca/meal-plan for more information on meal plan options for your second year and beyond.

DINE IN OR OUT

You may use your Flex Dollars to order in-home delivery (for example, pizza), to make selections from vending machines in residence and on campus or to dine at selected local restaurants that are our meal plan partners. When using your Flex Dollars for these options, alcoholic beverages are excluded and you pay regular retail prices (which include overhead costs and are subject to applicable taxes for off-campus purchases).

HOW DO I USE MY MEAL PLAN?

Your Western ONECard functions as both your student identification and your meal card. Your account will be credited with your full year's Residence Dollars and Flex Dollars prior to your arrival. The meal plan program is based on a **declining balance system**, meaning that when you buy food, the purchase amount will be deducted from the balance on your Western ONECard. You are in control of your own food credit budget and have complete flexibility in menu selection and eating times.

Where to use your meal plan

In addition to the eight residence dining halls, all of these places accept your residence meal plan!

ON CAMPUS

Ah-So Sushi | Angry Goose | Bento Sushi | Casa Burrito | Chambers Cafe | Chatime | DaVinci's Cafe | Einstein's Cafe | Ivey Eatery | Jugo Juice Manchu Wok | Noodles | Noodles Express | Noodle Box | Paramount Lebanese Kitchen | Pizza Pizza | Quesada | Starbucks | Subway | Tim Hortons

DINE OUT

Banana Burger | Barakat | Black Walnut | Burger Factory | Chef on Call | East Side Mario's | Grad Club | Grocery Checkout | King Richie's Pizzeria | Mr. & Mrs. Bao | Mucho Burrito | Omzzy's Shawarma | Subway | Swiss Chalet | The Grad Club | The Wave | The Spoke

ORDER IN

Barakat | Burger Factory | Chef on Call | East Side Mario's | Dominos | Jack Astor's | King Richie's Pizzeria | Mr. & Mrs. Bao | Mucho Burrito | Omzzy's Shawarma | Panago Pizza | Pizza Pizza | Swiss Chalet

Note: The above are subject to change.

By eating the majority of your meals in the residence dining halls, your food credit will last much longer.





Connect to Internet

We provide you with a high-speed wired connection in your room as well as wireless internet connectivity throughout your residence building.

Keeping you Connected

- Unlimited internet usage – no bandwidth limits
- Wireless internet service throughout residence
- Reliable wired connections in every room
- Excellent support team available year-round
- Included in your residence fees – no extra cost

What should I bring with me to residence?

Our wireless service offers a convenient way to connect throughout your residence. It is built for academic and personal smart phone, tablet, or laptop use. Make sure your device(s) support “WPA2-Enterprise” authentication, otherwise they may not be able to connect to the wireless service.

Our wired service can be used to provide a stable connection for your computer, game console or ethernet capable streaming device. If you forget your ethernet cable at home, fear not, a complementary cable can be picked up at your residence front desk.

What type of computer do I need to connect?

Almost any modern computer can connect! We support current versions of Windows, macOS and Chrome OS.

What if I need help?

Our excellent student support team is available on move-in days to help you get connected! Our friendly hotline staff are also available throughout the year to answer questions related to internet in residence.

Do I need to sign up for anything?

No, all students living in residence receive wired internet service in their bedroom and wireless service throughout their building. This is all included in your room fee at no extra charge.



Having a reliable, high-speed internet connection helps you keep on top of your academics. If you ever need assistance, our team is available seven days a week to keep you connected.



SAFETY AND SECURITY

Safety is a Shared Responsibility

In Residence:

- Front Desk Staff are available 24 hours a day by phone and in-person at residence front desks
- Access to buildings is restricted 24/7 by locked doors controlled by card access
- At designated times, guests must show valid photo ID, be signed in at the front desk upon entry to the residence and be accompanied by their host resident of the building at all times
- Residence Staff are available to respond to emergencies within the residence

On Campus:

Alert WesternU

Western is committed to maintaining a safe and healthy campus. Alert WesternU, powered by OnSolve MIR3, is Western's emergency mass notification system. Alert WesternU will quickly notify students, faculty and staff of emergencies that could present a threat to personal safety. All Western Main Campus and affiliate students, faculty and staff with a current @uwo.ca email address are automatically enrolled in the system.

In an emergency, immediate notification is crucial. Text to your mobile device is quicker than email. Consider adding a text number to your Alert WesternU account using your Western ID login credentials at alert.westernu.ca.

Campus Safety & Emergency Services (CSSES)

Western Special Constables are responsible for law enforcement and provide emergency and routine response on campus 24 hours a day, seven days a week. Western Special Constables support many community services and programs to help meet the safety needs of Western's diverse community, including personal safety and responsible drinking presentations, theft prevention tips, bicycle registration, security audits and safety-related print materials.

Emergency Blue Phones

Located throughout campus, emergency blue phones provide fast, free and direct communication to Campus Safety & Emergency Services in the event of a need for immediate assistance.

Student Emergency Response Team (SERT)

SERT is a student-run volunteer organization affiliated with Western Student Health Services. SERT responds to all medical emergencies on campus 24 hours a day, seven days a week. Recognized by the Ministry of Health as the first responder for Western, SERT is dispatched directly through Campus Safety & Emergency Services by calling 83300 from any campus phone or residence front desk. SERT services are completely free to use.

Western Foot Patrol

Foot Patrol is a free service that provides walk-safe escorts, deters crime through patrols and promotes safety awareness. Students can request a safe escort on the Main Campus and Affiliated University College campuses any day of the week. The program welcomes volunteers and accepts applications from students, staff and faculty.

Accessibility in Residence

Western Housing makes every reasonable effort to accommodate the needs of our residents who are members of a protected group and/or fall under a protected ground of discrimination. Our goal is to foster a sense of belonging for all students, including those with special needs or requirements. Accommodations may be granted based on physical, medical, mental, financial, dietary, religious, cultural or other needs.



Most of our residences are accessible to people with differing physical abilities. Clare Hall, Essex Hall, Elgin Hall, London Hall, Perth Hall and Ontario Hall have incorporated a number of barrier-free design features, including some specially-designed suites.

It is important to review our website (residence.uwo.ca/experience/accessibility) for detailed information on our

request criteria, as well as how to make a request in the myHousing Portal. Requests must be received by the Housing Office on or before June 3, 2026.

We caution that our residences may not be suitable for individuals with severe allergies, dietary or health-related concerns, or serious mental health concerns that require extraordinary accommodation.



Live on Campus After First Year

You can continue living in residence in your upper years and enjoy the benefits that it has to offer. Live a minute's walk from class with easy access to the gym and library. Take advantage of the flexibility to choose how you dine. Enjoy a homecooked meal or avoid doing those dishes by eating in the dining hall. You can also rest easy not having to worry about paying utilities or internet each month. With Western

as your landlord, those items are taken care of along with any repairs needed.

Be sure to apply early when applications become available as upper-year residence is limited and operates on a first-come, first-served basis.

FREQUENTLY ASKED QUESTIONS

Residence Admissions

The majority of first-year students are accommodated in double rooms, as they offer an increased opportunity to meet new friends and become part of a close-knit community.



How are residences assigned?

Assignments are made based on a computer-generated random number assigned to each student. Some of the residences may be filled by the time your number is reached. You will then be assigned to the next available residence on your list of preferences, as indicated in your Residence Placement Questionnaire responses. Students should be prepared to be placed in any of our 12 residences as there may only be availability in the student's eleventh choice depending on their computer-generated random number.

We also consider the information that you provide, including lifestyle information, building and roommate preferences, and other information you tell us about yourself.

When will I find out my building placement?

You will be informed in late July of your residence placement and will find out your room assignment a few days before move-in. If Housing is assigning your roommate, you will meet them upon arrival in September. We reserve the right to assign rooms based on availability, including combining multiple residents into rooms within reasonable limits of safety and comfort, in situations of high demand.

What if I have a preferred roommate?

You may request one roommate in any style of building. You will be placed with a requested roommate provided that:

- You both receive residence offers, submit your Residence prepayment and complete your Residence Placement Questionnaires before the deadline
- You both join the same roommate group in the myHousing Portal
- You both rank your preferences identically

Please note: You and your requested roommate must be in the same faculty/program in order to be placed together on a faculty-based Living-Learning Community floor.

Once you know your residence assignment in late July, if you and your requested roommate have been assigned to Elgin Hall, Essex Hall, Perth Hall, Ontario Hall or Alumni House, and you wish to share a suite with other students who have also been placed in the same residence, each student needs to forward a request to the Housing Office at housing@uwo.ca by the deadline. Requests for groups of three can only be accommodated for students placed in London Hall.

What are my chances of getting a single-room placement?

The four suite-style residences, Alumni House, Elgin Hall, Essex Hall, Lambton Hall and London Hall are comprised of two, three or four single bedrooms in each suite. In addition, traditional and hybrid-style residences also offer limited single rooms.

You may indicate your preference for a single room by checking the appropriate box on the online Residence Placement Questionnaire. However, we are unable to make any guarantees of single-room placement.

Do marks affect my assignment?

No. For most students your marks do not affect your placement in residence.

Scholarship recipients receiving awards from Western's National Scholarship Program*, Schulich Leader Scholarships and/or National Indigenous Scholarship are guaranteed their first choice of residence building and single-room accommodation in their first and second year.

Recipients of the Western Scholarship of Excellence are guaranteed one of their top three choices of residence building in their first and second year. Double or single room assignments are dependent on the random draw. Students will automatically be considered for the Western Scholarship of Excellence if you are admitted to an undergraduate program at Western's Main Campus directly from secondary school and are registered in first year full-time studies. No application is required.

Learn more on registrar.uwo.ca/student_finances/scholarships_awards/admission.

**Neen Hodgins National Entrance Scholarship, President's Entrance Scholarships, James Jenkins President's Entrance Scholarship for Black Students, Beryl Ivey Continuing Entrance Scholarship, Neen Hodgins President's International Entrance Scholarship, International President's Entrance Scholarships, and Faculty Entrance Scholarships.*

“

Living in residence allowed me to become involved in the University in a way that would not have been possible otherwise. Even now, it is the friends that I made within the residence system that serve as the bond connecting me to Western, even from across the Atlantic.

— Brian C.,
Rhodes Scholar*

* The Rhodes Scholarships are postgraduate awards supporting outstanding all-round students at the University of Oxford and provide transformative opportunities for exceptional individuals around the globe.





Accepting your Residence Offer

You are required to pay a \$900 prepayment to accept your residence offer on or before the deadline date indicated with your academic offer.

It is important to complete the online Residence Placement Questionnaire at myhousing.uwo.ca on or before June 3, 2026.

Changes to any residence or lifestyle preferences received after June 10, 2026 may not be considered.

DEADLINES

Your residence and tuition fees will be included on your statement of account in your Student Center (student.uwo.ca) once building assignments are released. Your Residence Contract and information regarding your residence building placement and move-in will be available in late July on the myHousing Portal (myhousing.uwo.ca). The first instalment of residence and tuition fees for first-year students is due by **August 4, 2026**. If your first instalment is not received by the deadline, your accommodation may be cancelled. For more information regarding payments and instalments, please visit the Registrar's Office website (registrar.uwo.ca).

SOMETHING TO CONSIDER

Living in residence is not for everyone. Each of our residences accommodate a high-density population of diverse individuals. Some students find that the requirements for cooperation, consideration, compromise and respect for authority demanded by this high-density lifestyle difficult. We strongly encourage these individuals to consider alternate accommodation.

CANCELLATION

Occasionally, students cancel their residence offer before the academic year commences. Half of the \$900 prepayment will be refunded if your notice of cancellation is received by the Housing Office no later than August 4, 2026. If you cancel your residence offer after that date, you will forfeit your \$900 residence prepayment.

Please note that in order to cancel your residence accommodation, you must complete the form on the myHousing portal. Please reach out to the Housing Office at housing@uwo.ca if you have any questions.

Residence Fees

Total Fees (Room Rate + Meal Plan)

Your total residence cost for the year includes both your room rate and mandatory meal plan. Add these together when planning your budget to see the full amount.

Room Rates

TRADITIONAL STYLE	Delaware Hall		Medway-Sydenham Hall		Saugeen-Maitland Hall				
	Shared Double	Private Single	Shared Double	Private Single	Shared Double	Private Single			
	\$10,450	\$11,280	\$10,260	\$11,040	\$10,260	\$11,040			
HYBRID STYLE	Perth Hall		Ontario Hall		Clare Hall		Bayfield Hall*		
	Shared Double	Private Single	Shared Double	Private Single	Shared Double	Private Single	Shared Double		
	\$11,790	\$13,110	\$12,070	\$13,170	\$12,910	\$13,170	\$10,860		
SUITE STYLE	Elgin Hall		Essex Hall		Lambton Hall*		London Hall		Alumni House
	Private Single		Private Single		Private Single		Private Single		Private Single
	\$13,620		\$13,620		\$12,980		\$13,420		\$11,160

*Meal plan is optional for Bayfield and Lambton Hall.

Meal Plan Options

Before selecting a meal plan, you should consider that Meal Plan One is recommended for students living in traditional- and hybrid-style residences without in-suite cooking facilities. Meal Plan Two is recommended for students in suite-style residences who plan to cook occasionally, often head home on weekends or those likely to try local restaurants around London. It's important to note that the Overhead and Capital Improvement Fee are non-refundable components of the meal plans.

Meal Plan One		Meal Plan Two	
Food Credit**	\$4,100	Food Credit**	\$3,500
Overhead	\$4,050	Overhead	\$4,050
Capital Improvement Fee	\$150	Capital Improvement Fee	\$150
Total Meal Plan Cost	\$8,300	Total Meal Plan Cost	\$7,700

**Food Credit (Refundable)

Incl. Residence Dollars \$3,550 and Flex Dollars \$550

**Food Credit (Refundable)

Incl. Residence Dollars \$2,950 and Flex Dollars \$550

More to Come

Check online at residence.uwo.ca in August for the Move-in Planning Guide, which includes information about:

- What to bring
- Move-in day schedule
- Orientation week
- Parking and more!



IMPORTANT DATES 2026

June 3	First-year residence prepayment due to the Housing Office
	Residence Placement Questionnaire due (<i>changes allowed until June 11</i>)
	Deadline for Residence Accessibility Requests to be submitted
Late July	Building assignment available online (<i>includes residence fee invoice and contract</i>)
August 4	Last day to cancel your residence and receive a refund of \$450 (<i>half of the residence prepayment of \$900</i>)
	First instalment of residence fees due* for first-year students
	<i>*Please note that failure to meet this deadline may result in the cancellation of your residence space.</i>
August 17	First instalment of residence fees due for upper-year students
September 5–7	Move-in days
September 9	Classes begin

IMPORTANT NUMBERS

Residence Admissions	519.661.3547
Office of Residence Education and Programs	519.661.3719
Residence Counselling and Student Support	needtotalk@uwo.ca
University Apartments (upper-year accommodations)	519.661.3250
Platt's Lane Estates (family accommodations)	519.679.4561
Off-Campus Housing	519.661.3550
Western University Switchboard	519.661.2111
Campus Safety & Emergency Service	519.661.3300
International Student Services	519.661.2111 ext. 89309
Registrar/Academic Admissions, Financial Aid Office (OSAP), Scholarships, Liaison Services, Tuition Fees	519.661.2100
Western Virtual Chat	westernchat.uwo.ca
Connect-IT Support Hotline	519.661.4225
Accessible Education	519.661.2147
Health & Wellness Services	519.661.3030
Careers and Experience	519.661.3559
1 on 1 Course Advising	launch@uwo.ca
University Students' Council	519.661.3574

Housing Office
Housing and Ancillary Services
Western University

Room 3C10, Ontario Hall
230 Sarnia Road, London
Ontario, CANADA N6G 0N2

519.661.3547
housing@uwo.ca
residence.uwo.ca



@westernuhousing



Published December 2025
Copyright © 2025 Western University

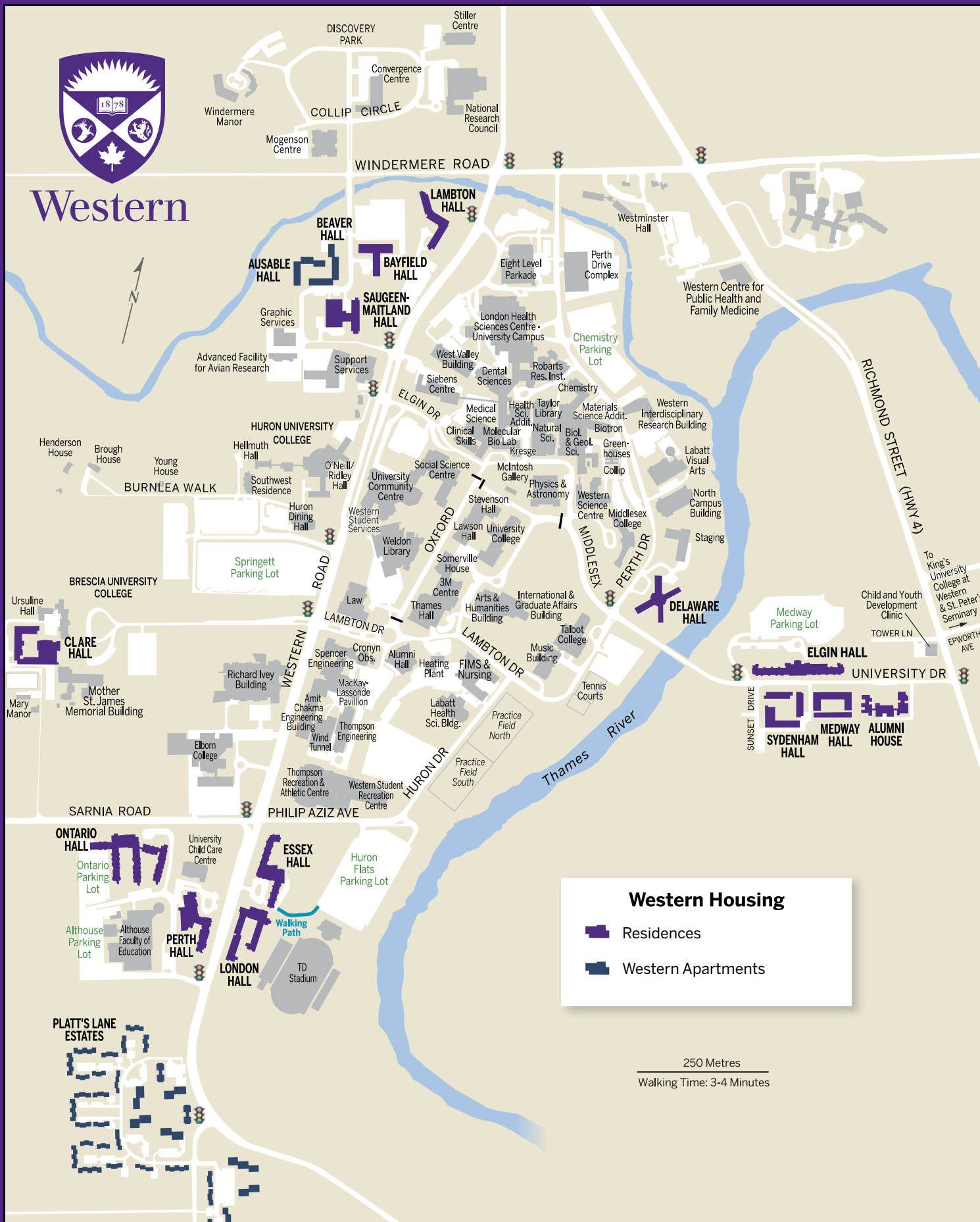

Western



Western Housing

-  Residences
-  Western Apartments

250 Metres

Walking Time: 3-4 Minutes