

# RESIDENCE OFFER BOOK 2024

Western  
UNIVERSITY • CANADA



We acknowledge that Western University is located on the traditional lands of the Anishinaabek, Haudenosaunee, Lūnaapéewak and Chonnonton Nations, on lands connected with the London Township and Sombra Treaties of 1796 and the Dish with One Spoon Covenant Wampum. With this, we respect the longstanding relationships that Indigenous Nations have to this land, as they are the original caretakers. We acknowledge historical and ongoing injustices that Indigenous Peoples (First Nations, Métis and Inuit) endure in Canada and we accept responsibility as a public institution to contribute toward revealing and correcting miseducation as well as renewing respectful relationships with Indigenous communities through our teaching, research and community service.



Medway-Sydenham Hall Residence

# Welcome



On behalf of the entire Housing team, we offer you a warm welcome to Western's residence community. We are committed to providing you with an incredible residence experience and are excited to show you the many benefits that life in residence can provide.

Residence Life engages and connects you to the University community and fosters your growth as a leader. We are here to assist you in achieving your academic goals by creating residence communities that maximize your potential for success. While in residence, you also have a unique opportunity to learn more about yourself and others, as well as experience meeting different people. There are ample opportunities for leadership and involvement, a range of activities and life-long friendships to be made!

Living in residence for the first year of your university life will support and enrich your academic experience. Our research consistently shows a strong relationship between living in residence and academic success. Living right on campus puts you at the centre of everything—you're a quick walk to class or to one of Western's many libraries. Residence provides easy ways to find others to form study groups, collaborate and prepare for exams. You also have convenient, exclusive access to study spaces. We strongly believe that your residence environment provides the positive support you need to enable you to concentrate on pursuing your academic goals.

All of our on-campus residences are about convenience—whether you are taking advantage of Western's state-of-the-art campus recreation centre or being just steps away from a bus stop that will enable you to explore the beautiful and vibrant city of London.

We are proud of our residence facilities and the variety of room options available to you. Please check our website for more information or let us know if we can assist you in any way.

Again, on behalf of the Department of Housing, welcome to Western University. Best wishes for a rewarding academic year.

A handwritten signature in black ink, appearing to read 'Chris Lengyell'.

**Christopher Lengyell**, Director of Housing

## What's Inside

- 4** The Residence Guarantee
- 5** Residence Advantages
- 6** Residence Amenities
- 7** Styles of Residence
- 11** Academic Success in Residence
- 12** Living-Learning Communities
- 14** Lifestyle-Based Floors
- 16** Leadership Opportunities
- 18** Here to Support
- 19** Residence Dining
- 20** Residence Meal Plan
- 22** Connect to Internet
- 23** Safety and Security
- 24** Commitment to Diversity
- 25** Accessibility in Residence
- 26** Residence Admissions FAQ
- 29** Residence Fees
- 30** Important Dates and Numbers

## THE RESIDENCE GUARANTEE

# A Place for *Everyone*

**You are invited to become an important part of our residence community, where Western students live and learn together.**

If you are a single student coming directly from high school and have received an offer of full-time, first year admission to Western University's Main Campus by mid-May, then accommodation is **GUARANTEED**.

*Please pay close attention to the deadline dates as outlined on page 30.*

Scholarship recipients receiving awards from Western's National Scholarship Program\*, the Schulich Leader Scholarship and the National Indigenous Scholarship are guaranteed their first choice of residence building and single-room accommodation.

If you are a recipient of the Western Scholarship of Excellence, you are guaranteed one of your top three choices of residence building. You will automatically be considered for the Western Scholarship of Excellence if you are admitted to an undergraduate program at Western's Main Campus directly from secondary school and are registered in first year full-time studies. No application is required.

You can learn more on Western's Admission Scholarship Program page.

*\* President's Entrance Scholarships, President's Entrance Scholarship for Black Students, Beryl Ivey Continuing Entrance Scholarship, International President's Entrance Scholarships, Faculty Entrance Scholarships*

If you're a high school student on a study permit in Canada and a recipient of Western's Continue-in-Canada Admission Scholarship, you will be guaranteed a space in residence for all four years of your undergraduate studies, in addition to a scholarship of \$40,000 over four years.

### The fine print:

First-year students who do not meet our guaranteed offer requirements are still eligible to apply to the residence waiting list if they are single and are academically admissible for full-time studies on Main Campus.

Students registering at Huron or King's University College or those enrolled in the Western-Fanshawe Collaborative BScN Program who start at the Fanshawe site are not eligible for residence at Western's Main Campus.

Students with families are encouraged to contact Platt's Lane Estates, our University-owned family accommodation.

Information, policies and procedures contained in this document are subject to change, pending new guidance and recommendations from the University and/or local/provincial/federal agencies and leaders.

**1<sup>st</sup>**

in the 'Residence Living' category in *Maclean's University Rankings* seven years in a row

**3**

building styles to choose from

**12**  
residences

conveniently located on campus—all within a 10-minute walk to class

**6,200**  
residence spaces

guaranteeing incoming first-year students a place in residence

**80+%**

of first-year students choose to live in residence, giving them an academic advantage and easing their transition to university



## Did you know?

Studies show that students living in residence achieved higher averages compared with their peers living off campus.\*

# Residence *Advantages*

### Academic edge

Students who live in residence are more successful academically. There are many programs in residence that support your academic efforts—'Professor Meet and Greet' events, exam review sessions, peer study groups and academic skills workshops—all right where you live!

### Clean and cared-for facilities

We're continually upgrading and renovating our buildings to ensure that you can enjoy high-quality, well-equipped accommodations. We also provide regular cleaning of common areas on your floor every day.

### Convenient and easy access

Living on campus means that you're always close to your classes, campus services and co-curricular involvement opportunities. Meeting with a professor or studying in the library is only a short walk away.

### Dining at ease

Our eight residence dining halls offer easy access to a diverse range of dining options. Our chefs prepare a wide selection of food in-house so there's always something new to try. You can dine in on campus, order in or dine out with our off-campus meal plan partners—all on your residence meal plan!

### Focus on safety

Every residence has a front desk that's only a call away, live-in Residence Dons that are here to support, Residence Safety Assistants that respond to overnight concerns and guest registration tables which are set up on the weekends. Someone is always available to help. Western Special Constables provide 24/7 patrols and emergency response service 365 days a year, while Foot Patrol provides safe escorts to walk students to their destinations on main campus and the Affiliate University Colleges at night. Western also has a Student Emergency Response Team which responds to on-campus medical emergencies.

### Growing your leadership skills

Expand your personal and professional skills through involvement in numerous academic, social, cultural and recreational activities just steps away from your door! Through a variety of events, you can gain valuable leadership skills to help you land your dream job. Residence Life has a number of involvement opportunities including Residents' Council, Residence Life Staff and the Residence Orientation Program.

### Internet connection

Residence offers easy access to high-speed internet and to academic resources such as OWL, the Western Library system and Western email. Students have convenient wireless access available throughout all residence buildings in addition to our high-speed wired internet service. Need help connecting? Our Connect-IT team is available to help you get connected on move-in days and all year long.

### Making new friends

Residence enables you to easily meet new people and make connections with hundreds of other first-year students. Making new friends is one of the best parts of living in residence.

### Seamless move-in

Once you arrive to Western, you'll receive a warm welcome and directions on where to go—making your move-in day stress-free for you and your family.

### Variety of building & room options

With 12 residence buildings in three different styles, you have a lot of different options to choose from—all of which offer the same great convenience, events and leadership opportunities.

EVERYTHING YOU NEED UNDER ONE ROOF

# Residence Amenities

- Workout rooms, music practice rooms and laundry facilities
- Our eight residence dining halls provide delicious, home-cooked meals. You are never more than a few minutes' walk away from your closest dining hall
- Main lounges for residence events—equipped with ping-pong and/or pool tables, plenty of couches and TVs
- Safety is important to us— Access to our buildings or residential areas is restricted 24/7 by a locked door controlled by card access
- Regular caretaking from our facilities management staff
- Study rooms available in your building



front desk services,  
accessible in person or  
by phone



Caretaking staff will provide  
regular sanitization of  
common spaces and light  
housekeeping during periods  
of low vacancy (i.e. fall and  
spring reading week)



Living-Learning  
Communities in our  
buildings that group  
residents who share the  
same faculty, program  
or interests



upper-year student  
leaders living in  
residence, ready to  
connect you to campus  
and assist you with any  
questions you may have



# Traditional-Style Residence

Delaware Hall | Medway-Sydenham Hall |  
Saugeen-Maitland Hall

A combination of single and double rooms along a hallway where residents share common washrooms with members of their floor community. Washrooms are separate for men and women and some floors have additional all-gender washrooms depending on the building.

- Most economical room rate
- Easy to make friends and meet others
- Strong sense of community and belonging
- Floor washrooms with private showers are cleaned daily
- About 30 students on each floor

We offer single-gender rooms in traditional-style buildings. Mixed-gender rooms are only offered if students explicitly request the option.

*Note: Floor plans are for illustrative purposes only and may not reflect the exact layout of every residence building.*

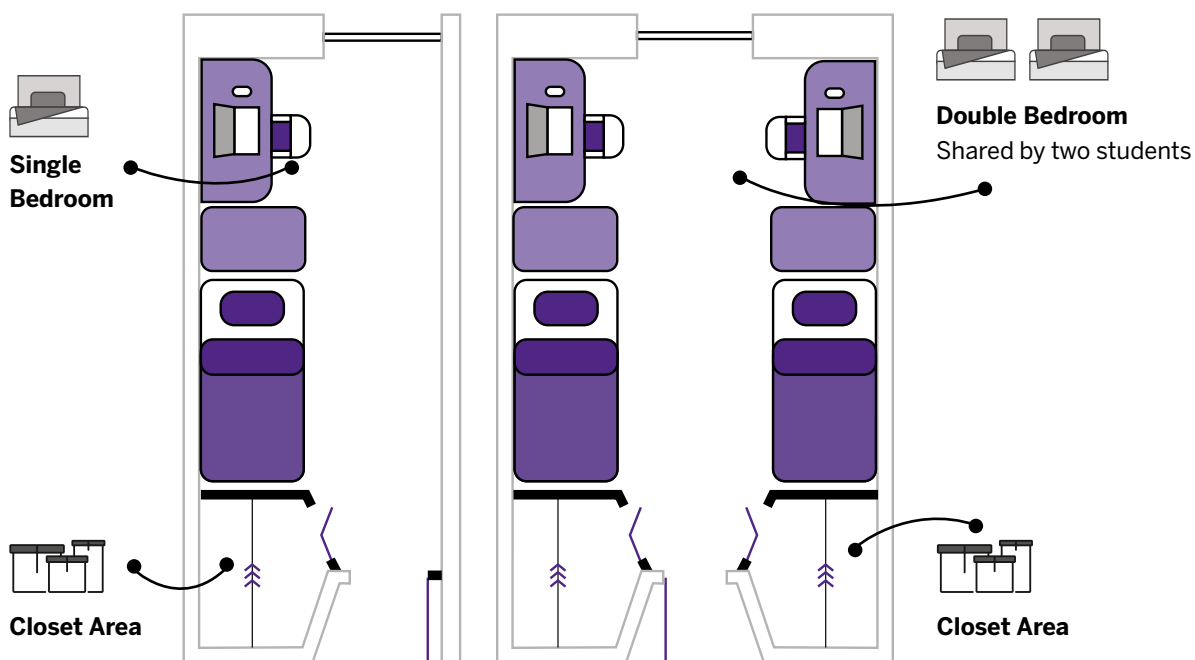

# Hybrid-Style Residence

Bayfield Hall | Clare Hall | Ontario Hall | Perth Hall

Mostly double rooms (and some singles) where students share a bedroom and a private washroom. Bayfield Hall suites also contain a shared kitchen and living area.

- Strong sense of community similar to traditional-style
- Extra storage in common area of semi-suite
- Extra common-area sink in semi-suites with double rooms
- Cleaning supplies available at front desks

Clare Hall is an all-women residence. Mixed-gender rooms or suites are only offered in other buildings if students explicitly request the option.

*Note: Floor plans are for illustrative purposes only and may not reflect the exact layout of every residence building.*

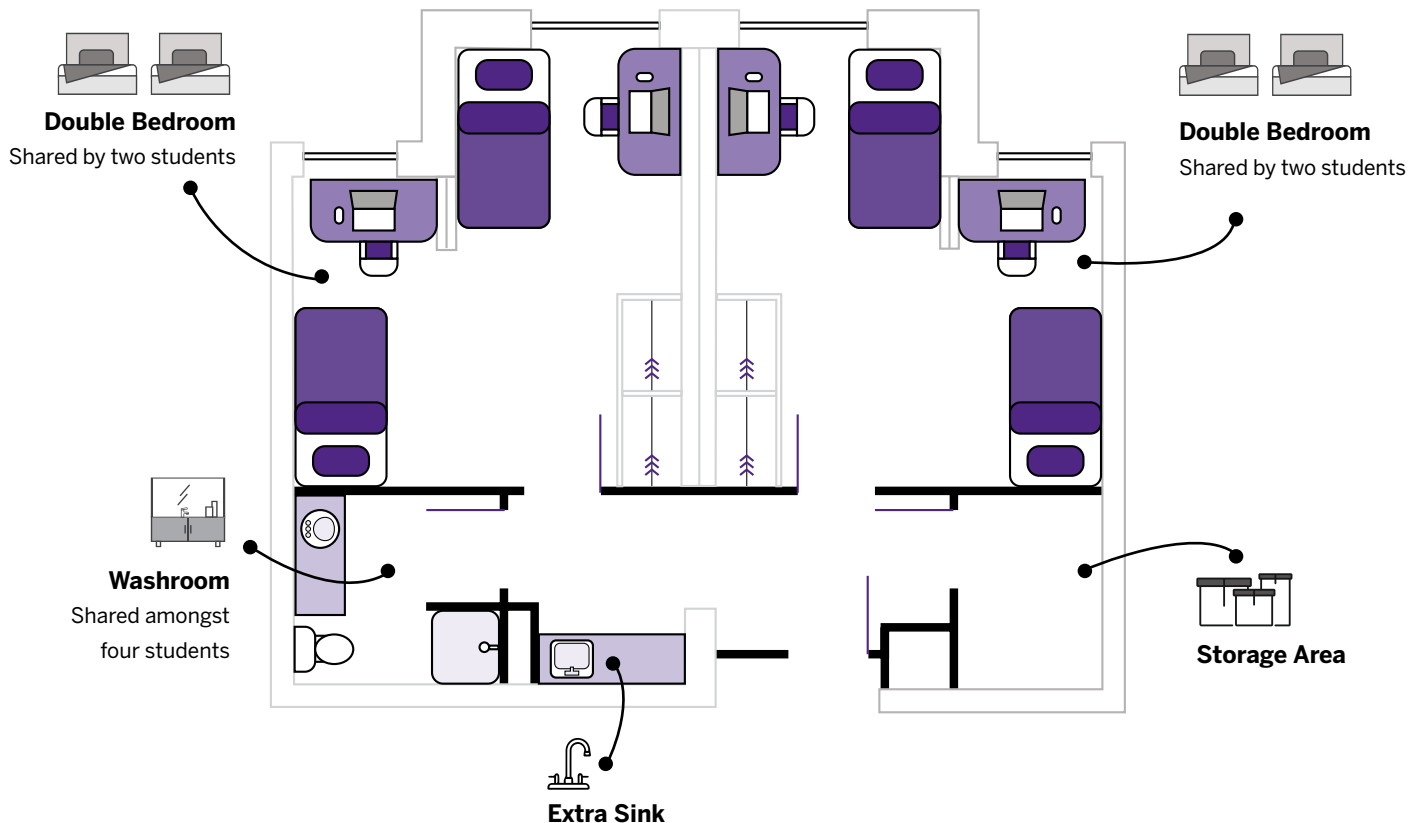

# Suite-Style Residence

Elgin Hall | Essex Hall | Lambton Hall |  
Alumni House | London Hall

Two, three or four single rooms form a suite and share a kitchenette and living area, as well as one or two washrooms, depending on the building.

- Geared towards independent living with more domestic responsibilities
- Has increased privacy with individual bedrooms and fewer students sharing washroom facilities
- Shared kitchen and living area space
- Cleaning supplies available at front desks

We offer single-gender and mixed-gender suites depending on students' identified preferences.

*Note: Floor plans are for illustrative purposes only and may not reflect the exact layout of every residence building.*

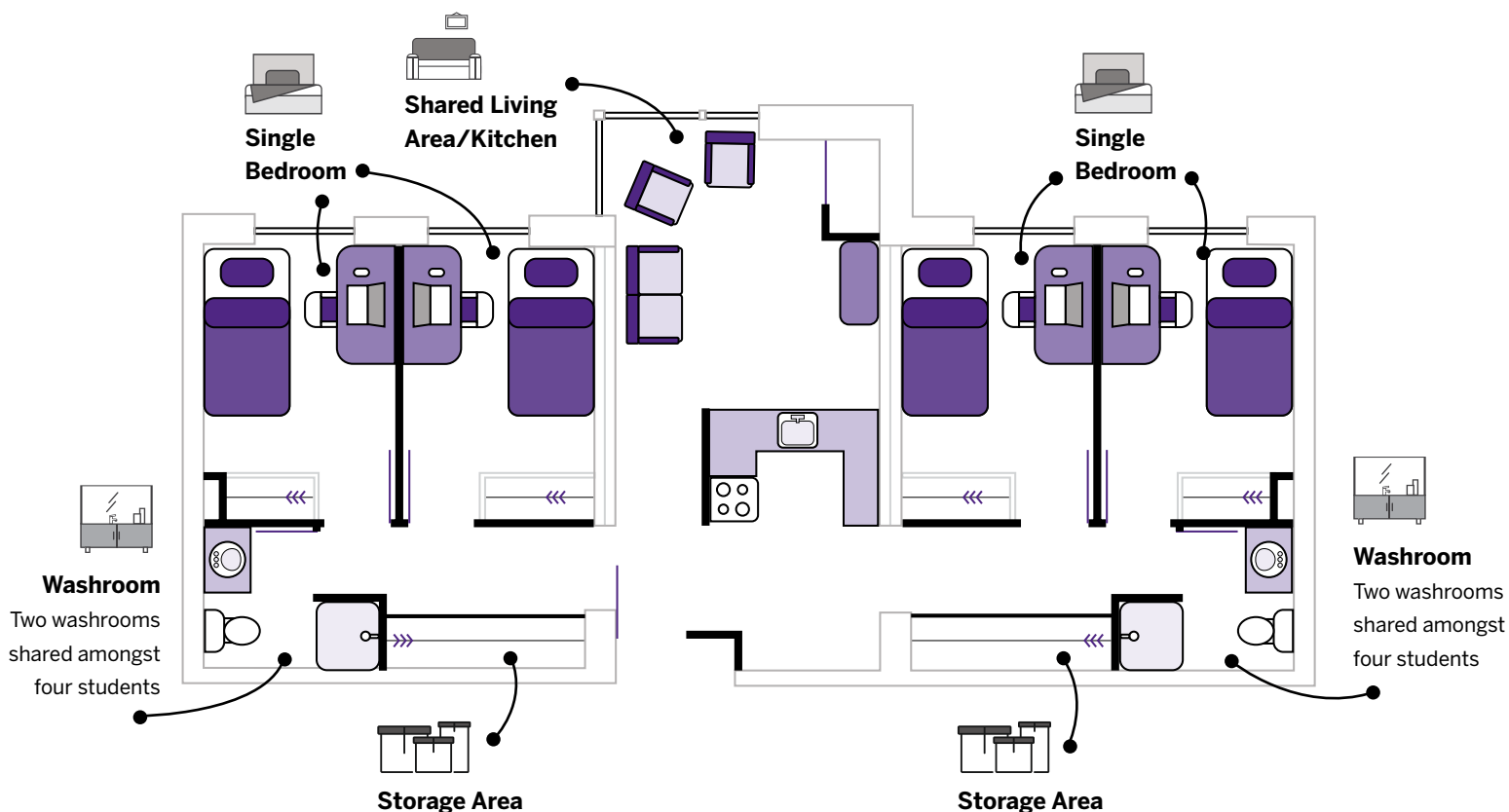



# How to Choose Your Residence

## HOW ARE RESIDENCES ASSIGNED?

We ask you to rank all of our residences, from most-desired to least-desired, on your Residence Placement Questionnaire. Consider the style of residence, single- or mixed-gender room options, cost and the Living-Learning Community offerings. There are some single rooms available, though we can't guarantee this option.

Building assignments are made using a computer-generated number, randomly assigned to each student. Placement is based on your ranked preferences of buildings. If your most preferred residence in your ranked list is filled by the time your number is picked, you will be assigned to the next available residence in your list of preferences.

## HOW DO I RANK MY RESIDENCE CHOICES?

We offer the same programs and activities in every residence. More importantly, the same strong sense of community and belonging develops among members of each floor community in all the residences, big or small. You will be able to walk to the centre of campus in ten minutes from any residence. If you don't get one of your top choices, not to worry as each residence building offers a close-knit community, unique culture and opportunities to take advantage of!

## HOW DO YOU MATCH ROOMMATES?

We make every effort to match people with similar lifestyle habits, such as whether they study with or without music in the background, whether they prefer to go to bed early, how often they clean their room and more, based on their answers on the Residence Placement Questionnaire.

We respect that a person may wish to live with students irrespective of their or others' gender identity or expression. Both single-gender and mixed-gender rooms and suites are available for students to choose from when

you fill in the online Residence Placement Questionnaire at [myhousing.uwo.ca](https://myhousing.uwo.ca).

Please note that attitudes towards smoking, vaping, cannabis and alcohol use, along with age, take precedence in the placement process over other lifestyle habits.

## About Mixed-Gender Housing in Residence

If you select the option for 'Mixed-Gender Suites' in the online Residence Placement Questionnaire, we will not consider your gender identity when placing you in a suite with other students. You will be matched with someone based on lifestyle preferences (tidiness, study habits, etc.).

As a result, you might be assigned a suitemate(s) of the same gender, or with someone whose gender identity is different than yours. Mixed-gender housing is an opt-in process and accommodation will be available based on demand.

Although we are happy to support students who choose mixed-gender housing in all room styles, we find that it works best in suite-style and single-hybrid style. Should you wish to live in mixed-gender housing in a shared double-bedroom, reach out to [housing@uwo.ca](mailto:housing@uwo.ca) to manage your request.

Clare Hall is an all-women residence. Mixed-gender housing option is not available in this building.

*Please note that your gender preference only applies to your suite. All but a few of our floors and residences are mixed-gender.*

# Academic Success in Residence

**Learning is not limited to opening a book or participating in a lecture. We learn from every moment, situation and personal encounter.**

Western promotes a residence atmosphere that's conducive to sleep and study at all times. Our staff are available to respond to any noise disturbances that might occur. Residence Life Staff and Sophs help floormates set guidelines to maintain a mutual level of respect and understanding of one another's need for an environment that encourages academic study.

- 24-hour quiet hours are strictly enforced during exam periods, while 11:00 p.m.–8:00 a.m. quiet hours are set for regular school nights
- Structured programs are run throughout the year to connect you with others in your classes and with professors from your faculty and program

- Organized study groups and academic support sessions are available throughout the year
- In addition to the wired internet service in your bedroom, wireless service is available in all residences

Studying for university takes personal discipline and self-management skills no matter where you live. Give yourself an academic edge by living and learning in residence!

## Study Rooms

Enjoy a casual, relaxed setting where you can work on your studies with some friendly support right in your residence. Residence Education Advisors (REAs) regularly use these spaces to meet one-on-one with students and run workshops designed to help students succeed academically.



## Our Learning Goals

We want you to get the most out of your experience at Western—and living in residence is the start of that journey. Residence events and programs are designed with three key learning goals in mind that will teach you how to thrive in university and in life after graduation.



**Intellectual Engagement:** Through interactions with faculty, staff and peers, you will be challenged to think critically, apply knowledge and connect classroom learning to life experiences.



**Citizenship:** By living in a community, exploring new cultures and learning more about social issues, you'll discover and refine your perspective, individuality and impact on society.



**Self-Awareness:** Learn to reflect on personal growth and change—whether it be physical, psychological, social or intellectual and gain the ability to recognize a realistic self-concept relating to confidence, integrity and personal limitations.

“Residence Life provides many opportunities that will allow you to succeed. You will be surrounded by hundreds of other students who are eager to work collaboratively on course work. Orientation Leaders and Residence Life Staff also work very hard to ensure that you have the opportunity to meet your personal and academic goals”.

— Nicholas M., Social Science



## Did you know?

*More than 1,200 residents attend the “Get the Scoop” workshop every September to learn about academic transition from Residence Education Advisors and Learning Skills Counsellors.*

# Living-Learning Communities

**One of our most effective, high-impact and immersive programs in residence.**

Living-Learning Communities (LLCs) are floors in residence for students that want to live with other students that may share commonalities with them. There are floors for students who share a faculty/program, have the same shared identity and/or lived experience or those who want to support diversity and inclusion.

LLCs are developed to give students a more enriched living and learning environment, combining academic integration, personal development and community engagement.

LLCs offer students additional benefits, including:

- An easy way to meet peers who share the same interests and academic goals
- Easier access to study groups and social events
- Programs and events tailored to fit their needs, goals and interests

- Multiple upper year mentors who have shared lived experiences
- Enhanced opportunities for career and life-skill development
- Experiential learning opportunities connected with their community
- An increased sense of belonging in a particularly supportive environment

**All LLCs are optional for students and there is no additional cost to live on any of these floors.**

**\*Acceptance into these communities is not finalized until move-in.**

## DELAWARE HALL



Music



Nursing

## ELGIN HALL



Scholar's  
Electives  
Program



Medical  
Sciences

## ESSEX HALL



Engineering

## MEDWAY-SYDENHAM HALL



Health  
Sciences



Arts &  
Humanities



Science

## PERTH HALL



Media,  
Information  
& Technoculture



Management &  
Organizational  
Studies

## ONTARIO HALL



Integrated  
Science



2SLGBTQ+  
and Ally



School of Advanced  
Studies in Arts &  
Humanities

## SAUGEE-MAITLAND HALL



Engineering



Kinesiology



Management &  
Organizational Studies



## 2SLGBTQ+ AND ALLY COMMUNITY

Do you feel passionate about expanding your knowledge in the area of gender identity, sexuality and social issues? The 2SLGBTQ+ and Ally Community welcomes all members of the Twospirited, Lesbian, Gay, Bisexual, Transgender, Transsexual, Queer and Questioning community, and their Allies (those who support and positively affirm all members of the Queer community). This community offers a supportive environment for students questioning their gender and/or sexuality, advocates for 2SLGBTQ+ rights and strives for an environment where all residents feel celebrated and empowered.



# Lifestyle-Based Floors

In addition to our Living-Learning Communities, we also offer Lifestyle-Based Floors. Students who share the same lifestyle can choose to live together on these floors, available in Saugeen-Maitland Hall and Medway-Sydenham Hall.

**Substance-free floors** are for students (regardless of age) who commit to a substance-free lifestyle and want to live among others who have chosen the same. Each member on the floor is responsible for maintaining the integrity of this option.

**Quieter lifestyle floors** are for those who prefer to live in an environment with greater restrictions on noise. Standards for quiet are set by the residents of each floor.

**Clare Hall** is an all-women residence, based on demand.

## Selection Process

If you are interested in applying to one or more of the Living-Learning Communities or Lifestyle-Based Floors, please indicate your preferences in the online Residence Placement Questionnaire. You will be placed accordingly, based on availability.

Students who apply to our 2SLGBTQ+ and Ally Community answer brief questions to assist in the placement process.

All of these floors are arranged as demand dictates. Certain options may not be offered if we don't have sufficient student interest to fill a full floor. While we do our best, we cannot guarantee placement on the floor of your choice.





## LEADERSHIP OPPORTUNITIES

# Stay Involved and Grow Your *Leadership Skills*

**At Western, we believe that experiential learning plays an important role in students' academic success.**

There are hundreds of student leadership positions available in residence—from Residents' Council to Residence Life Staff positions. By taking advantage of these opportunities, you will be able to leverage your skills, gain valuable experience and provide assistance to others, while also developing applicable leadership competencies for your future career.

### Residence Dons

Residence Dons are part-time, paid positions for upper-year students. Each community is assigned a Residence Don who lives on the floor and serves as a link between students and

the University. Their number one priority is to help make your Western experience the best it can be by answering questions, organizing activities, connecting you to campus resources and upholding residence policies.

### Residence Education Advisors

Residence Education Advisors (REAs) are Residence Life Staff who are upper-year, full-time students trained to provide the support and assistance students need to make their academic transition to university successful.

### Residents' Council

Residents' Council are elected or selected representatives of the residents. They organize social activities and programs including intramural sports, formals, special outings and study groups.

### Residence Sophs

Residence Orientation Leaders, also known as 'Residence Sophs', are upper-year students who volunteer their time to share their own experience and help first-year students in their transition to university. Sophs are known as the 'spirit keepers' on campus, energizing students during Orientation Week, facilitating move-ins in September and providing peer support throughout the year.

### Connect-IT Support Team

The team provides technical support to students in residence. This part-time position for upper-year students combines customer service experience and an opportunity to apply technical skills acquired during our annual staff training in August. The benefits of working with this team include competitive compensation, training, on-campus location, flexible hours, a student-run environment and an opportunity to expand your technical skills.

### Front Desk Staff

Front Desk Staff look after our reception areas in the residence building lobbies. They provide front-line customer service, answer phones 24/7, greet guests, issue replacement keys, coordinate mail deliveries, dispatch on-duty Residence Life Staff to handle concerns and take maintenance requests. Part-time hours available for students.

### Guest Registration

Guest Registration Staff are responsible for supporting Housing's Visitor Policy, by ensuring the students entering Western's main campus residences are registered residence students and/or registered guests. Staff are stationed at residence entrances during evenings, weekends and other high-traffic times. Part-time hours available for students.

### HAS Street Team

Street Team members are part-time student staff who support the Division of Housing and Ancillary Services (HAS). They use their campus experience to offer guided tours of residences and apartments to prospective students and their families, and also promote ancillary services (i.e., Hospitality Services and Western Bookstore) to the campus community.

“

*Being on Residence Staff is a unique way to discover more about yourself, expand your social relationships and feel connected to campus. I wanted to finish my undergrad in a meaningful way, and considering this role was something I wanted to do, it seemed like a perfect fit!”*

— Elise





# We are here to *Support*

The Housing Office team of professionals are experienced in dealing with students' transition from high school to university life. We are committed to creating a supportive residence community that maximizes your potential for success.

## **Office of Residence Education and Programs**

The Office of Residence Education and Programs (OREP) works with Student Experience, Western International, the University Students' Council and other departments on campus to organize various social and learning activities to create an engaging environment for residents to support their transition to university life.

## **Residence Life Coordinators**

Residence Life Coordinators are full-time employees of the University who live and work in the residences. They are responsible for promoting an atmosphere of academic achievement, community living, as well as the enhancement of student learning outside of the classroom.

## **Residence Safety Coordinators**

Residence Safety Coordinators are responsible for the afterhours emergency and safety responses in residence and regularly liaise with partners such as Campus Safety and Emergency Services. Their primary focus is on community management and student support, and can help connect residents to supports on campus and in the London community.

## **Residence Safety Assistants**

Residence Safety Assistants are full-time staff members dedicated to the community management and student support needs during peak periods of student activity including evenings, overnights and weekends. They conduct regular rounds of the buildings and help connect students

to resources, as well as respond to concerns such as noise complaints and emergencies in residence.

## **Residence Counselling & Student Support**

Residence Counselling offers confidential counselling services, free of charge, to students living in residence on a wide variety of issues including (but not limited to): adjustment to university, anxiety, depression, academic stress, motivation, grief, sexuality, gender identity, relationships, suicidal thoughts, self-harm, social skills, self-esteem and greater understanding of self. Our team of mental health professionals works closely with other campus departments to promote coordinated services for students living in residence and can facilitate referrals to specialized services when needed.

## **Facilities Management**

Facilities Management Staff work during the day to ensure a clean and well-maintained living environment. They are also responsible for repairs and maintenance work.

## **Residence Conduct**

Residence is the largest classroom on campus. When concerns arise regarding student behaviour, Residence Conduct staff members work with the student to educate about harm reduction and ensure they have the best experience possible. On occasion, conduct staff members also use a restorative approach to address harm to the community.

## **Dining Hall Staff & Registered Dietitian**

Dining Hall Staff prepare your meals and snacks throughout the day and our Registered Dietitian can help answer any nutrition questions that you may have. Our chefs at the interactive stations will cook customized meals for you.



# Residence Dining

**Our dining halls serve diverse, globally inspired, homemade meals using locally sourced ingredients when possible.**

## **Convenience**

We're proud to offer eight conveniently located residence dining halls—you are never more than a few minutes' walk away from your closest dining hall. You can also use your meal plan at any of our residence dining halls, so it's easy to share meals with your friends from other buildings—you'll love the convenience!

## **Choices and flexibility**

Check out our selection of affordable, à la carte menu options. You choose, and pay for, as much or as little of an item as you wish! Each dining hall features hot entrées prepared in-house by our skilled culinary teams, a full fruit and salad bar, deli bar, sushi, soups and convenient grab-and-go items.

## **Tailored to your dietary needs**

It's easy to make healthy food choices in our residence dining halls, even for students with dietary restrictions. Our menus feature a wide variety of options including several plant-based, allergen-friendly, gluten free and halal selections. To assist students with managing their dietary and allergen needs, dietary and Health Canada allergen identifiers are displayed throughout the serveries to help you make an informed decision. This makes it easier for students with dietary restrictions to find safe foods.

At Western, we support students living with food allergies. If you have a food allergy or other dietary restriction, we strongly encourage you to self-identify. Please consider completing the 'Food Allergies and Dietary Needs' section of the myHousing portal, submitting a Residence Accessibility Request on the myHousing Portal and sending an email to our Registered Dietitian ([nutritionservices@uwo.ca](mailto:nutritionservices@uwo.ca)) prior to moving in. Your safety is a shared responsibility so allow us to assist you in making an informed choice. For more information please refer to our nutrition website ([nutrition.uwo.ca](http://nutrition.uwo.ca)).

## Sample Menu

**Below is a sample of a residence dining hall menu. All students in residence (except those in Lambton Hall and Bayfield Hall) are required to purchase a meal plan.**

### **BREAKFAST**

Eggs to Order  
 Hayter's Farm Turkey Bacon  
 'Beyond' Brand Breakfast Sausage  
 Breakfast Sandwiches (with and without meat)  
 Baked Beans  
 Breakfast Potatoes  
 Smoothies and Smoothie Bowls  
 Fresh Fruit  
 Yogurt (regular and vegan)  
 Hot and Cold Cereals (regular and gluten free)  
 Breads, Muffins and Pastries (regular and gluten free)

### **LUNCH**

Chicken Shawarma Bowl  
 Eggplant Caprese  
 Teriyaki Meatballs  
 Coconut Crusted Tilapia  
 Vegan Quinoa and Black Bean Burger  
 "Beyond" Italian Sausage and Vegetable Toss  
 Moroccan Lentil Stew  
 Fresh Market Vegetables

### **DINNER**

Buttermilk Fried Western Style Hot Chicken (regular and plant-based)  
 BBQ Back Ribs  
 Penne with Roasted Cherry Tomatoes  
 Basil & Feta Cheese Pasta  
 Fresh Market Vegetables  
 Jalapeno Cheddar Cornbread  
 Marinated Coleslaw  
 Fresh Cut Fry Bar Assorted Garnishes  
 Fresh Sandwich Deli

### **SOUP STATION (ALL DAY)**

Homemade Butternut Squash Soup  
 Prepared Italian Wedding Soup  
 Beef Chili



*Did you know?*

*The meal plan works like a debit card with a declining balance.*

## Where to use your Meal Plan

In addition to the eight residence dining halls, all of these places accept your residence meal plan!

### ON CAMPUS

Ah-So Sushi | Angry Goose Food Truck | Bento Sushi | Casa Burrito | Chambers | Chatime | Casa Burrito | DaVinci's | Einstein's | Ivey Eatery | Manchu Wok | Noodles | Noodles Express | Noodle Box | Paramount Lebanese Kitchen | Pizza Pizza | Quesada | Starbucks | Subway | The FIXX | Tim Hortons

### DINE OUT

Barakat | Black Walnut | Burger Factory | Chef on Call | East Side Mario's | Grocery Checkout | King Richie's Pizzeria | McDonald's | Mucho Burrito | Omzzy's Shawarma | Pizza Pizza | Subway | Swiss Chalet | The Grad Club | The Wave | The Spoke | Turmeric

### ORDER IN

Barakat | Burger Factory | Chef on Call | East Side Mario's | Dominos | Jack Astor's | King Richie's Pizzeria | Mr. & Mrs. Bao | Mucho Burrito | Omzzy's Shawarma | Pizza Pizza | Swiss Chalet | Turmeric

*Note: The above are subject to change.*

## UNDERSTANDING YOUR MEAL PLAN

# Meal Plan

**Residence meal plan is comprised of two main components: the overhead fee and the food credit.**

### Overhead Fee

The overhead fee is used to maintain and operate the dining halls. This includes labour, capital costs, equipment, etc. There is no food credit value to the overhead fee and it is non-refundable.

### Food Credit

There are two types of food credit in your meal plan— Residence Dollars and Flex Dollars:

- **Residence Dollars** are used at residence dining halls and on-campus eateries. The cost of food purchased in the residence dining halls is reduced and tax-exempt to reflect that the overhead has been paid. When purchasing at on-campus eateries, you will pay full retail price but tax-exemption still applies.
- **Flex Dollars** can be used for on-campus vending machines and at our meal plan partner restaurants found both on and off campus. Many take-out/delivery options are available. Off-campus flex purchases are subject to full retail price plus applicable taxes.

## WILL MY MEAL PLAN CREDIT LAST ALL YEAR?

Whether the meal plan will cover all of your meals for the academic year very much depends on your eating habits. As a light to average eater, if you purchase the majority of your meals in residence, the food credit should last for the academic year. You can add more food credit online at any time and are not required to pay further overhead costs when doing so.

## WHAT IF I HAVE FOOD CREDIT LEFT OVER BY THE END OF THE YEAR?

At the end of the academic year, any unused food credit (Residence Dollars and Flex Dollars) can be transferred to a Campus Meal Plan for the following year. Alternatively, you may request any unused food credits to be applied as a credit back to your Student Center account. Remember, the overhead fee is non-refundable.

## DINE IN OR OUT

You may use your Flex Dollars to order in-home delivery (for example, pizza), to make selections from vending machines in residence and on campus or to dine at selected local restaurants that are our meal plan partners. When using your Flex Dollars for these options, alcoholic beverages are excluded and you pay regular retail prices (which include overhead costs and are subject to applicable taxes for off-campus purchases).

## HOW DO I USE MY MEAL PLAN?

Your Western ONECard functions as both your student identification and your meal card. Your account will be credited with your full year's Residence Dollars and Flex Dollars prior to your arrival. The meal plan program is based on a **declining balance system**, meaning that when you buy food, the purchase amount will be deducted from the balance on your Western ONECard. You are in control of your own food credit budget and have complete flexibility in menu selection and eating times.

**By eating the majority of your meals in the residence dining halls, your food credit will last much longer.**





# Connect to Internet

We provide you with a high-speed wired connection in your room as well as wireless internet connectivity throughout your residence building.

## Keeping you Connected

- No bandwidth limits on internet usage
- Exclusive wireless internet service residence-wide
- Excellent service & support team
- No extra costs

### What should I bring with me to residence?

Our wired service provides the highest quality service and is the best connection for academic work, financial transactions and gaming. You need to bring an Ethernet cable in order to connect your laptop to our high-speed wired network.

Our convenient wireless service is best suited for casual smart phone, tablet or laptop use. If your computer does not have an ethernet port, you will also need to bring an external network adapter with you to residence.

### What type of computer do I need to connect?

Almost any computer can connect! Our staff support computers with all current versions of Windows, macOS and Chrome OS. current versions of Windows, macOS and Chrome OS.

### What if I need help?

Our excellent student support team is available on move-in days to help you get connected! Our friendly staff and hotline are also available throughout the year to answer questions related to internet in residence. On your move-in day, you will also receive an Internet Connection Guide that contains instructions to help you connect your devices.

### Do I need to sign up for anything?

No, all students living in residence receive wired internet service in their bedroom and wireless service throughout their building. This is all included in your room fee at no extra charge.



Having a reliable, high-speed internet connection helps you keep on top of your academics. If you ever need assistance, our team is available seven days a week to keep you connected.



## SAFETY AND SECURITY

# Safety is a Shared Responsibility

### In the Residences:

- Front Desk Staff are available 24 hours a day by phone and in-person at residence front desks
- Access to buildings is restricted 24/7 by locked doors controlled by card access
- At designated times, guests must show valid photo ID, be signed in at the front desk upon entry to the residence and be accompanied by their host resident of the building at all times
- Residence Staff are available to respond to emergencies within the residence

### On Campus: Alert WesternU

Western is committed to maintaining a safe and healthy campus. Alert WesternU, powered by OnSolve MIR3, is Western's emergency mass notification system. Alert WesternU will quickly notify students, faculty and staff of emergencies that could present a threat to personal safety. All Western Main Campus and affiliate students, faculty and staff with a current @uwo.ca email address are automatically enrolled in the system.

In an emergency, immediate notification is crucial. Text to your mobile device is

quicker than email. Consider adding a text number to your Alert WesternU account using your Western ID login credentials at [alert.westernu.ca](http://alert.westernu.ca).

### Campus Safety & Emergency Services (CSES)

Western Special Constables are responsible for law enforcement and provide emergency and routine response on campus 24 hours a day, seven days a week. Western Special Constables support many community services and programs to help meet the safety needs of Western's diverse community, including personal safety and responsible drinking presentations, theft prevention tips, bicycle registration, security audits and safety-related print materials.

### Emergency Blue Phones

Located throughout campus, emergency blue phones provide fast, free and direct communication to Campus Safety & Emergency Services in the event of a need for immediate assistance.

### Residence Staff

Residence Staff are available to respond to emergencies and student concerns at all hours. During the day, Residence Life Coordinators and Residence

Area Managers ensure safety and the coordination of support. Overnight, each Residence has a dedicated safety team of Residence Safety Assistants and Residence Safety Coordinators who promote a sense of safety and security within the residences.

### Student Emergency Response Team (SERT)

SERT is a student-run volunteer organization affiliated with Western Student Health Services. SERT responds to all medical emergencies on campus 24 hours a day, seven days a week. Recognized by the Ministry of Health as the first responder for Western, SERT is dispatched directly through Campus Safety & Emergency Services by calling 911 from any campus phone or residence front desk. SERT services are completely free to use.

### Western Foot Patrol

Foot Patrol is a free service that provides walk-safe escorts, deters crime through patrols and promotes safety awareness. Students can request a safe escort on the Main Campus and Affiliated University College campuses any day of the week. The program welcomes volunteers and accepts applications from students, staff and faculty.



# Commitment to Diversity

Living in residence means that you have rights. You also have responsibilities. It's essential that you respect the rights of your fellow residents, including our commitment to diversity. Respecting others will make them more likely to respect you in turn. Residence living requires a spirit of mutual respect and cooperation.

**Take care of yourself**  
**Take care of each other**  
**Take care of this place**

We're all part of Western's diverse community. We embrace, appreciate and celebrate people of all races, nationalities, sexes, ages, gender identities and expressions, affectional and sexual orientations, socioeconomic statuses, spiritual practices, abilities and any other dimension of identity. Our community is strengthened by diversity and the growth fostered by an inclusive residence environment. Every person has equal worth and deserves to be treated with

dignity and respect.

We live and learn together, maintaining an environment of mutual respect and interpersonal curiosity, while striving to have positive interactions with one another. We can learn from each other to gain a greater understanding and appreciation for our fellow people.

We're responsible for our actions and our behaviour reflects our values. Any form of abuse, harassment, threat or violence is incompatible with our philosophy and will not be tolerated. We don't accept ignorance, anger, alcohol or substance abuse as a valid excuse, reason or rationale for negative behaviour. Together, we create a supportive, inclusive community for students to live, learn and flourish.

## We are here to help

If our housing features or roommate options do not support your gender identity/expression and/or sexual/affectional orientation, please contact [housing@uwo.ca](mailto:housing@uwo.ca) to discuss a placement that is right for you.

**12%**

of our residents are international, coming from 122 countries across the world

**17%**

of our residents identify as lesbian, gay, bisexual, transgender, queer or questioning

**93%**

of our residents are 18 or younger when they arrive on move-in days

**20%**

of our residents hold part-time jobs while attending Western

# Accessibility in Residence

Western Housing makes every reasonable effort to accommodate the needs of our residents who are members of a protected group and/or fall under a protected ground of discrimination. Our goal is to foster a sense of belonging for all students, including those with special needs or requirements. Accommodations may be granted based on physical, medical, mental, financial, dietary, religious, cultural or other needs.



Most of our residences are accessible to people with differing physical abilities. Clare Hall, Essex Hall, Elgin Hall, London Hall, Perth Hall and Ontario Hall have incorporated a number of barrier-free design features, including some specially-designed suites.

It is important to review our website ([residence.uwo.ca/experience/accessibility](https://residence.uwo.ca/experience/accessibility)) for detailed information on our

request criteria, as well as how to make a request in the myHousing Portal. Requests must be received by the Housing Office on or before June 5, 2024.

We caution that our residences may not be suitable for individuals with severe allergies, dietary or health-related concerns, or serious mental health concerns that require extraordinary accommodation.

## FREQUENTLY ASKED QUESTIONS

# Residence Admissions

**The majority of first-year students are accommodated in double rooms, as they offer an increased opportunity to meet new friends and become part of a close-knit community.**



### How are residences assigned?

Assignments are made based on a computer-generated random number assigned to each student. Some of the residences may be filled by the time your number is reached. You will then be assigned to the next available residence on your list of preferences, as indicated in your Residence Placement Questionnaire responses. Students should be prepared to be placed in any of our 12 residences as there may only be availability in the student's twelfth choice depending on their computer-generated random number.

We also consider the information that you provide, including lifestyle information, building and roommate preferences, and other information you tell us about yourself.

### When will I find out my building placement?

You will be informed in late July of your residence placement and will find out your room assignment a few days before move-in. If Housing is assigning your roommate, you will meet them upon arrival in September. We reserve the right to assign rooms based on availability, including combining multiple residents into rooms within reasonable limits of safety and comfort, in situations of high demand.

### What if I have a preferred roommate?

You may request one roommate in any style of building. You will be placed with a requested roommate provided that:

- You both receive residence offers, submit your Residence prepayment and complete your Residence Placement Questionnaires before the deadline
- You both join the same roommate group in the myHousing Portal
- You both rank your preferences identically

*Please note: You and your requested roommate must be in the same faculty/program in order to be placed together on a faculty-based Living-Learning Community floor.*

Once you know your residence assignment in late July, if you and your requested roommate have been assigned to Elgin Hall, Essex Hall, Perth Hall, Ontario Hall or Alumni House, and you wish to share a suite with other students who have also been placed in the same residence, each student needs to forward a request to the Housing Office at [housing@uwo.ca](mailto:housing@uwo.ca) by the deadline. Requests for groups of three can only be accommodated for students placed in London Hall.

### What are my chances of getting a single-room placement?

The five suite-style residences, Alumni House, Elgin Hall, Essex Hall, Lambton Hall and London Hall are comprised of two, three or four single bedrooms in each suite. In addition, traditional and hybrid-style residences also offer limited single rooms.

You may indicate your preference for a single room by checking the appropriate box on the online Residence Placement Questionnaire. However, we are unable to make any guarantees of single-room placement.

If you have checked the box indicating your preference for a single room and are initially assigned a double room, you may still be reassigned to a single room before you move in.

### Do marks affect my assignment?

No. For most students your marks do not affect your placement in residence.

Scholarship recipients receiving awards from Western's National Scholarship Program\*, the Schulich Leader Scholarship and/or

the National Indigenous Scholarship are guaranteed their first choice of residence building and single-room accommodation.

If you are a recipient of the Western Scholarship of Excellence, you are guaranteed one of your top three choices of residence building. Double or single room assignments are dependent on the random draw. You will automatically be considered for the Western Scholarship of Excellence if you are admitted to an undergraduate program at Western's Main Campus directly from secondary school and are registered in first year full-time studies. No application is required.

You can learn more on [Western's Admission Scholarship Program page](#).

\* President's Entrance Scholarships, President's Entrance Scholarship for Black Students, Beryl Ivey Continuing Entrance Scholarship, International President's Entrance Scholarships, Faculty Entrance Scholarships

“

*Living in residence allowed me to become involved in the University in a way that would not have been possible otherwise. Even now, it is the friends that I made within the residence system that serve as the bond connecting me to Western, even from across the Atlantic.*

— Brian C.,  
Rhodes Scholar\*

\* The Rhodes Scholarships are postgraduate awards supporting outstanding all-round students at the University of Oxford and provide transformative opportunities for exceptional individuals around the globe.





# Accepting your Residence Offer

You are required to pay a \$900 prepayment to accept your residence offer on or before the deadline date indicated in your academic offer.

It is important to complete the online Residence Placement Questionnaire at [myhousing.uwo.ca](https://myhousing.uwo.ca) on or before June 5, 2024.

Changes to any residence or lifestyle preferences received after June 12, 2024 may not be considered.

## **SOMETHING TO CONSIDER**

Living in residence is not for everyone. Each of our residences accommodate a high-density population of diverse individuals. Some students find that the requirements for cooperation, consideration, compromise and respect for authority demanded by this high-density lifestyle difficult. We strongly encourage these individuals to consider alternate accommodation.

# Residence Fees

## DEADLINES

Your residence and tuition fees will be included on your statement of account in your Student Center ([student.uwo.ca](http://student.uwo.ca)) once building assignments are released. Your Residence Contract and information regarding your residence building placement and move-in will be available in late July on [myhousing.uwo.ca](http://myhousing.uwo.ca). The first instalment of residence and tuition fees for first-year students is due by **August 1, 2024**. If your first instalment is not received by the deadline, your accommodation may be cancelled. For more information regarding payments and instalments, please visit the Registrar's Office website ([registrar.uwo.ca](http://registrar.uwo.ca)).

## CANCELLATION

Occasionally, students cancel their residence offer before the academic year commences. Half of the \$900 prepayment will be refunded if your notice of cancellation is received by the Housing Office no later than August 1, 2024. If you cancel your residence offer after that date, you will forfeit your \$900 residence prepayment.

Please note that in order to cancel your residence accommodation, you must complete the form on the myHousing portal. Please reach out to the Housing Office at [housing@uwo.ca](mailto:housing@uwo.ca) if you have any questions.

## 2024–2025 RESIDENCE ROOM & MEAL PLAN RATES September–April (8 Months)

All rates shown below are subject to change/approval by Western's Senate and Board of Governors.

	RESIDENCE	FIXED COSTS (Non-Refundable)			TOTAL FOOD CREDIT** (Refundable)	TOTAL FEES (Room & Meal Plan)
		TYPE	ROOM CHARGE*	MEAL PLAN OVERHEAD		
TRADITIONAL STYLE	Delaware Hall	Double Room	\$9,570	\$3,870	\$3,070	\$16,510
	Medway-Sydenham Hall Saugeen-Maitland Hall	Single Room	\$10,290	\$3,870	\$3,070	\$17,230
HYBRID STYLE	Ontario Hall	Double Room	\$10,920	\$3,870	\$3,070	\$17,860
	Perth Hall	Single Room	\$11,860	\$3,870	\$3,070	\$18,800
	Clare Hall	Single Room	\$11,520	\$3,870	\$3,070	\$18,460
	Bayfield Hall	Double Room	\$10,100	Optional Meal Plan		\$10,100
SUITE STYLE	Elgin Hall Essex Hall London Hall	Single Room	\$12,200	\$3,870	\$3,070	\$19,140
	Alumni House	Single Room	\$10,470	\$3,870	\$3,070	\$17,410
	Lambton Hall	Single Room	\$11,860	Optional Meal Plan		\$11,860

\* Residence room charge covers all utilities (water, heat, electricity), wired and wireless Internet, and includes a laundry card with a \$50 credit.

\*\* Please refer to the chart below for the meal plan food credit breakdown.

## \*\*2024–2025 TOTAL FOOD CREDIT (Refundable)

RESIDENCE DOLLARS	FLEX DOLLARS	TOTAL FOOD CREDIT
\$2,570	\$500	\$3,070

# More to Come

Check online at [residence.uwo.ca](https://residence.uwo.ca) in August for the Move-in Planning Guide, which includes information about:

- What to bring
- Move-in day schedule
- Orientation week
- Parking and more!



## IMPORTANT DATES 2024

<b>June 5</b>	First-year residence prepayment due to the Housing Office
	Residence Placement Questionnaire due ( <i>changes allowed until June 12</i> )
	Deadline for Residence Accessibility Requests to be submitted
<b>Late July</b>	Building assignment available online ( <i>includes residence fee invoice and contract</i> )
<b>August 1</b>	Last day to cancel your residence and receive a refund of \$450 ( <i>half of the residence prepayment of \$900</i> )
	First instalment of residence fees due* for first-year students
	<i>*Please note that failure to meet this deadline may result in the cancellation of your residence space.</i>
<b>August 15</b>	First instalment of residence fees due for upper-year students
<b>August 31–September 2</b>	Move-in days
<b>September 5</b>	Classes begin

## IMPORTANT NUMBERS

Residence Admissions	<b>519.661.3547</b>
Office of Residence Education and Programs	<b>519.661.3719</b>
Residence Counselling and Student Support	<b><a href="mailto:needtotalk@uwo.ca">needtotalk@uwo.ca</a></b>
University Apartments (upper-year accommodations)	<b>519.661.3250</b>
Platt's Lane Estates (family accommodations)	<b>519.679.4561</b>
Off-Campus Housing	<b>519.661.3550</b>
Western University Switchboard	<b>519.661.2111</b>
Campus Safety & Emergency Service	<b>519.661.3300</b>
International & Exchange Student Centre	<b>519.661.2111 ext. 89309</b>
Registrar/Academic Admissions, Financial Aid Office (OSAP), Scholarships, Liaison Services, Tuition Fees	<b>519.661.2100</b>
Western Virtual Chat	<b><a href="https://westernchat.uwo.ca">westernchat.uwo.ca</a></b>
Connect-IT Support Hotline	<b>519.661.4225</b>
Accessible Education	<b>519.661.2147</b>
Health & Wellness Services	<b>519.661.3030</b>
Careers and Experience	<b>519.661.3559</b>
Summer Academic Orientation	<b><a href="mailto:saostaff@uwo.ca">saostaff@uwo.ca</a></b>
University Students' Council	<b>519.661.3574</b>

Housing Office  
Housing and Ancillary Services  
Western University

Room 3C10, Ontario Hall  
230 Sarnia Road, London  
Ontario, CANADA N6G 0N2

519.661.3547  
[housing@uwo.ca](mailto:housing@uwo.ca)  
[residence.uwo.ca](http://residence.uwo.ca)

   @westernuhousing



Published March 2024  
Copyright © 2024 Western University

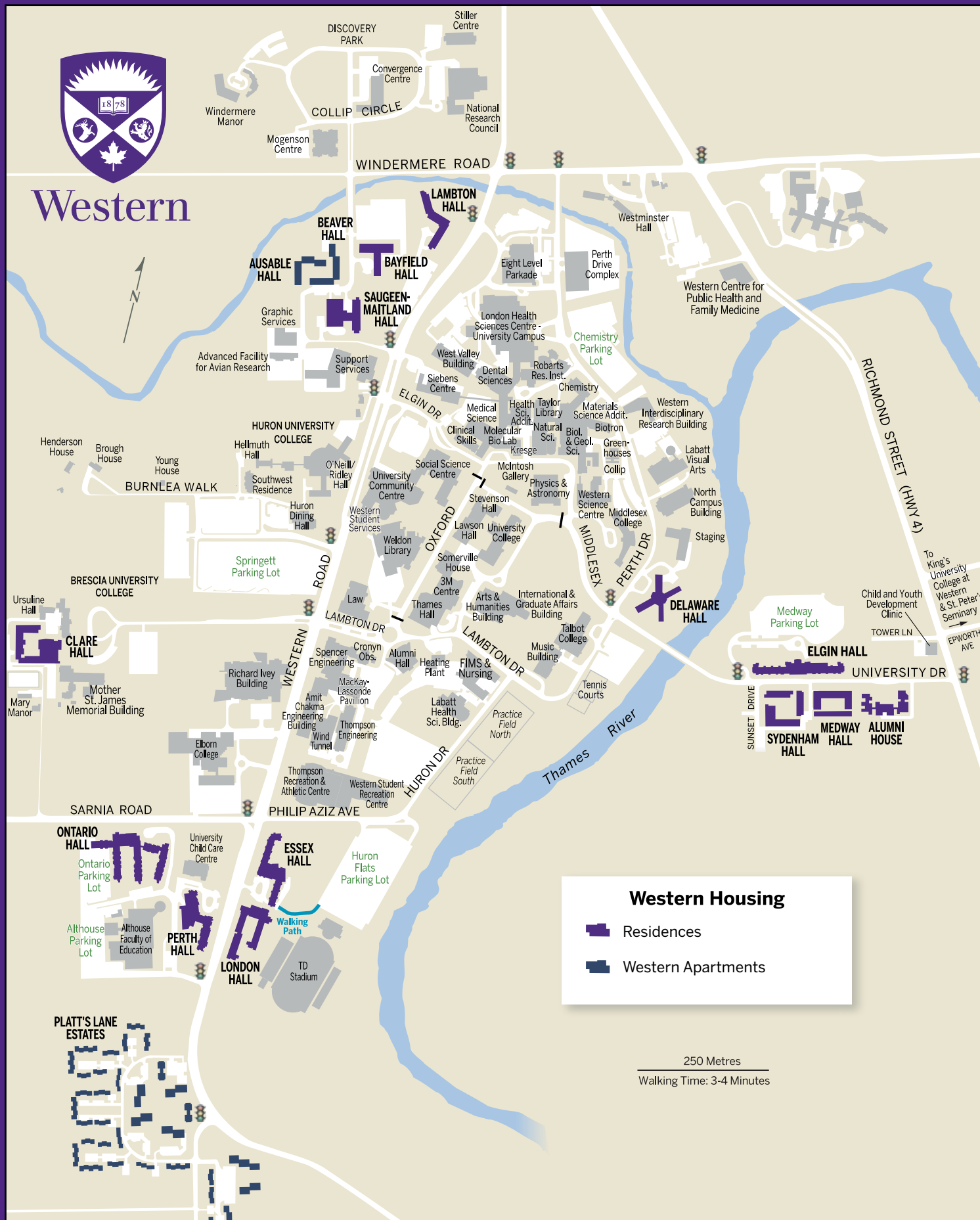

# Western



## Western Housing

-  Residences
-  Western Apartments

250 Metres

Walking Time: 3-4 Minutes